



SCHNEIDTECHNIK

Industrievertretung

Handelsvertretung

Consulting

# General Catalogue

We represent

***elaxa***®



dal 1946

**Eastman**®



## Vorstellung

Heute erhalten Sie unser erweitertes Programm über Schneidwerkzeuge zur Konfektion Ihrer Technischen Textilien und Verbundstoffe.

Mit **Eastman®** vertreten wir in Zentral-Europa den Technologieträger für Schneidtechnik der USA. Seit über 125 Jahren existiert **Eastman®** und baut heute die schnellsten und robustesten automatischen Schneidtische der Welt. Von allen installierten Anlagen werden mittlerweile über 50% in der Verbundstoffindustrie eingesetzt.

Mit unserem Partner **RASOR®** Italien ist es uns gelungen unser 20-jähriges Know-How in der Entwicklung von Schneidmaschinen umzusetzen, welche exakt auf die Bedürfnisse der Textil- und Verbundstoffindustrie abgestimmt sind.

**elaxa®** Akkuscheren+ Schneideinheiten, Made in Germany stellen die neueste Generation an Akkutechnik und die Möglichkeit von automatischem 2- und 3D Schnitt dar.

Auch Ihre Schneidaufgaben liegen uns am Herzen. Sichern Sie sich jetzt schon Ihre Verbindung zu den effektivsten Technologien am Markt.

Für einen persönlichen Kontakt stehen wir Ihnen jederzeit gerne zur Verfügung.



Mit herzlichen Grüßen aus Solingen  
Rainer Hückelhoven  
Geschäftsführer

## Content:

### RASOR

About

Battery shears

Electrical cutters

Manual bench cutters

Sportline

Pneumatic shears

Rail systems

Built-in units

Spare blades



P. 4

P. 5 - 9

P. 10 - 11

P. 12 - 15

P. 16 - 17

P. 18 - 21

P. 22

P. 23 - 32

P. 33



### EASTMAN

About

Automatic cutting tables

Feeding systems

Spare blades f. automatic cutting tables

Straight knives

Round knives

Falcon rail system

Rubber slitter and rag cutter

Spare blades for manual machines

Battery shears

# Eastman®

P. 34 - 35

P. 36 - 39

P. 40

S. 41

P. 42

P. 43 - 44

P. 45

P. 46

P. 47

P. 58



**elaxa®** Battery shears + built-in units

P. 48 - 51

### RH Schneidtechnik

Pneumatic shears

Rubber cutters

Battery shears

Oscillation cutter /

HSGM Heat cutters

Manual scissors

RH Service

Rotary-cutters

Stanley knives and blades



P. 52 - 53

P. 54

P. 55 - 58

P. 59

P. 60

P. 62 - 77

P. 78

P. 80 - 81

P. 82 - 83





Die Firma Rasor® Elettromeccanica S.r.l. wurde 1946 von den zwei Geschäftspartnern Spinelli und Ciminaghi in Mailand gegründet. Damit können wir auf mehr als 60 Jahre Erfahrung in Bau und Entwicklung von Elektro- und Druckluftscheren und Einbau-Schneidaggregaten zurückblicken.

Ursprünglich für den Einsatz im textilen Bereich gedacht, werden die Rasor® Produkte heute auch in vielen anderen Bereichen verwendet: im Verbundstoff-, Fahrzeug-, Nautik- und Sportsektor, sowie in der Möbelerzeugung.

Die Firma Rasor® zeichnet sich durch die hohe Produktionstiefe aus: Entwicklung, Bau aller Maschinenelemente, Verpackung und Lieferung finden in unseren Betriebsgebäuden statt. Unseren qualifizierten Mitarbeitern, die im Geiste der Firmengründer ausgebildet wurden, liegt die Einhaltung eines hohen Qualitätsstandards am Herzen. Dieser Qualitätsstandard führt zu ständigen Verbesserungen der Produktqualität sowie zur Erforschung und Entwicklung neuer Materialien und Technologien.



**Sponsoring Giacomo Ricci**

Dadurch ist Rasor® bereits seit langer Zeit ein Maßstab im Bereich der Schneidesysteme für Technische Textilien, Verbundstoffe, Dämmstoffe, Polsterstoffe und andere. Die große Zufriedenheit unserer Kunden zeugt von der Qualität unserer Arbeit.

Das Rasor® Qualitätssystem überwacht alle Arbeitsschritte, um den hohen Anforderungen unserer Kunden in den Bereichen der Produktqualität, Liefertreue und Lagerbestände zu entsprechen. Jeder einzelne Bestandteil der Produkte wird genauestens geplant und hergestellt, um optimale Leistungen zu garantieren.

Unsere Erzeugnisse entsprechen den neuesten Sicherheitsstandards und sind mit Sicherheitsschaltern und stufenlos verstellbarem Fingerschutz ausgerüstet. Entsprechend den hohen Qualitätsstandards haben sie ein Stahl-Bronze-Getriebe und eine halbautomatische Schleifeinrichtung.

## Battery shears

### RASOR RS1

**RARS1:** for textiles, canvas, leather, PVC, rubber, plastic film, carton

**RARS1S:** for technical textiles like aramid, PBO, Dyneema, carbon and fiberglass

- Blades with carbide inlay
- LED-laser for cutting control
- Switching between permanent / interrupted cutting



item code	description
<b>RASOR battery-shears RS1</b>	
<b>RARS1S</b>	RASOR Battery shears RS1S for technical textiles. Set contains: 2 rechargeable batteries, charging unit, charging station, 2 cutting heads (microserrated), tool for blade exchange, operating instructions
<b>RABA RS02</b>	Spare cutting head for RARS1S
<b>RARS1</b>	RASOR Battery shears RS1 for textiles & rubber. Set contains: 2 rechargeable batteries, charging unit, charging station, 2 cutting heads, tool for blade exchange, operating instructions
<b>RABA RS01</b>	Spare cutting head for RARS1
<b>RABA RS03</b>	Set of 2 pcs. rechargeable battery Li-ION 3,6V - 5,0Ah

Technical details: weight just 370g, cutting capacity: up to 1500g/m<sup>2</sup>

## Battery shears

### RASOR NERA PRO

Hand-held, battery driven cutting tool for cutting light Aramid, and glass-fibres, foamed material, fleece and further technical textiles up to 9mm thickness.

- developed for industrial cutting business
- Metal gear for good stability
- Speed: 1000r pm
- time for re-charging: 4h



item code	description
<b>RASOR battery-shears NERA PRO</b>	
<b>RANERA PRO</b>	RASOR battery shears NERA PRO, power 35W, battery 3.6V-2.4Ah (Li-Ion ®), max. cutting capacity: 9mm, round blade Ø 50mm (2.0"), high-speed-steel , weight 580g (incl. battery)

Configuration: bronze / steel coupling gear, variable finger-protection. Set contains: 2 rechargeable batteries, charging unit, charging station, tool for blade exchange, operating instructions



## Battery shears

### RASOR BOBCUT **NEW**

RASOR Battery shears BOBCUT incl. 2 batteries

- developed for industrial cutting business
- Metal gear for good stability
- Brushless, maintenance-free drive
- High productivity thanks to low weight with optimal handling
- Max. cutting capacity: 20mm



Charge level indicator



LED-Beleuchtung



Sicherheitsschalter



Batteries, charging station and power plug



Artikel-Code	Beschreibung
<b>RASOR Akkuscher BOBCUT</b>	
<b>RABOBCUT</b>	RASOR Bobcut battery shears, power 250 W, 2 x battery Li-Ion 16V, 2Ah, HSS-blade Ø 70mm (2,75"), 850rpm, max. cutting capacity: 20mm, weight: 1,1kg (incl. Battery)

Configuration: bronze / steel coupling gear, variable finger-protection. Set contains: 2 rechargeable batteries, spare blade, charging station, power plug, tool for blade exchange

## Battery shears

### RASOR ZERO 702

Hand-held, battery driven cutting tool for cutting Aramid, glass-fibres, PVC, rubber, foamed material, fleece and further technical textiles up to 18mm thickness.

- One of the strongest battery-driven scissors in the market
- continuously variable speed 600 rp/m - 1000 rp/m
- time for re-charging: max. 55 minutes



item code	description
<b>RASOR battery-shears ZERO702</b>	
<b>RATAZERO702</b>	RASOR battery shears ZERO702, power 400W, battery 18V-6,0 Ah, blade Ø 70mm, high-speed-steel, max. cutting capacity 15mm, weight 1,9kg (incl. battery)
<b>RABABAT18</b>	replacement battery 18V-6,0 Ah for RASOR battery shears Zero702

Configuration: bronze / steel coupling gear, semi-automatic push-button sharpening, continuously variable finger-protection, continuously variable cutting speed.



## Battery shears

### RASOR FORZA86

Hand-held, battery-driven cutting tool for cutting technical textiles, rubber and elastomers up to 22mm height

- continuously variable speed 600 rp/m - 1000 rp/m
- time for re-charging: max. 55 minutes



item code	description
<b>RASOR battery-shears FORZA86</b>	
<b>RAFORZA86</b>	RASOR battery shears Forza86, power 400W, battery 18V-6,0 Ah, blade Ø 86mm, high-speed-steel, max. cutting capacity 22mm, weight 2.1kg (incl. battery)
<b>RABABAT18</b>	replacement battery 18V-6,0 Ah for RASOR battery shears Forza 86 and Zero702

Configuration: bronze / steel coupling gear, semi-automatic push-button sharpening, continuously variable finger-protection, continuously variable cutting speed.

## Hand-held electrical scissors

### RASOR hand-held electrical scissors, 50mm blade

For technical textiles and elastomeres

- developed for industrial cutting business
- High productivity thanks to low weight with optimal handling
- semi-automatic push-button sharpening without removing knife



**DS504**



**DS503MT**

item code	description
<b>RASOR electrical scissors</b>	
<b>RADS504</b>	Electrical scissors 90W / 220V, max. cutting capacity 9mm, 6-edge-blade , Ø 50 mm (1.96") with hard-metal counterblade, 1,800 rp/min, weight 950g
<b>RADS503MT</b>	Electrical scissors 55W / 220V, max. cutting capacity 9mm, 7-edge-blade, Ø 50 mm (1.96") with welded hard-metal counterblade, 1.500 U/min, 950g. Slim shaped shear foot for cutting alongside moulds ( <b>Mould Trim</b> )

Configuration: bronze / steel coupling gear, semi-automatic push-button sharpening, continously variable finger-protection

## Hand-held electrical scissors

### RASOR OPTIMA

Hand-held electrical scissors for cutting Aramid, glass-fibres, PVC, rubber, foamed material, fleece and further technical textiles up to 18mm thickness.

- Most effective cutting because of low weight with best handling and low service requirements
- most powerful cutting machine in its engine-power-class
- new with 150W power



**Optima702**



**Optima703**

item code	description
<b>RASOR electrical scissorsOptima</b>	
<b>RAOPTIMA702</b>	RASOR electrical scissors OPTIMA 702, 150W / 230V, 4-, 6- or 10-edge blade, Ø 70mm, HSS with hard-metal counter-blade, r.p.m. 1500, max. cutting capacity 15mm, weight: only 1.1kg
<b>RAOPTIMA703</b>	RASOR electrical scissors OPTIMA 703, 150W / 230V, 4-, 6- or 10-edge blade, Ø 70mm, HSS with hard-metal counter-blade, r.p.m. 1500, max. cutting capacity 15mm, weight: only 1.1kg

Configuration: bronze / steel coupling gear, semi-automatic push-button sharpening, continuously variable finger-protection

## Hand-held electric bench cutter

### RASOR hand-held electric bench cutter with easy gliding base-plate D100

For natural textiles and carpets

- developed for industrial cutting business
- high cutting performance at low service requirement
- Especially suitable for natural textiles as felt, fleece, wool and cotton



item Code	description
RASOR electric bench cutter with base plate – 220V	
<b>RAD100</b>	RASOR electrical scissors 90W / 220V, max. cutting capacity 35mm, circular knife Ø 100 mm (4") with diaphragm, 1,000 rp/m, 2.95kg

Configuration: bronze / steel coupling gear, semi-automatic push-button sharpening, continuously variable finger-protection

## Hand-held electric bench cutter

### RASOR hand-held electric bench cutter with easy gliding base-plate D86P2

For natural textiles and carpets

- developed for industrial cutting business
- high cutting performance at low service requirement
- Especially suitable for natural textiles as felt, fleece, wool and cotton



item code	description
RASOR electric bench cutter with base plate– 220V	
<b>RAD86P2</b>	RASOR electrical scissors 90W / 220V, max. cutting capacity 25mm, 5-edge knife Ø 86 mm (3.4"), 850 rp/min, weight: 2.9kg

Configuration: bronze / steel coupling gear, semi-automatic push-button sharpening, continuously variable finger-protection



## Hand-held electric bench cutter

### RASOR hand-held electric bench cutter with easy-gliding baseplate SW100 and SW12

For technical textiles and elastomeres

- developed for industrial cutting business
- high cutting performance at low service requirement



item code	description
RASOR electric bench cutter with base plate– 220V	
<b>RASW100</b>	RASOR electrical scissors 90W / 220V, max. cutting capacity 35mm, 6-edge knife Ø 100 mm (4.0"), hard-metal counterblade, 850 rp/min, 2.95kg
<b>RASW12</b>	RASOR electrical scissors 190W / 220V, max. cutting capacity 50mm, 8-edge knife Ø 120 mm (4.7"), 850 rp/min., hard-metal counterblade, with easy-gliding base plate, weight: 3.4kg

Configuration: bronze / steel coupling gear, semi-automatic push-button sharpening, continously variable finger-protection

## Hand-held electric bench cutter

### **RASOR hand-held electric bench cutter with easy-gliding baseplate SW12M**

For heavy technical textiles and rubber

- developed for industrial cutting business
- high cutting performance at low service requirement
- central foot for cutting high-ply and rigid materials



item code	description
<b>RASOR electric bench cutter with base plate– 220V</b>	
<b>RASW12M</b>	RASOR electrical scissors 350W / 220V, max. cutting capacity 50mm, 8-edge knife Ø 120 mm (4.7"), hard-metal counterblade, easy-gliding base plate, modified gear with higher and 500 rp/min., blade in central position, weight 4.5kg

Configuration: bronze / steel coupling gear, semi-automatic push-button sharpening, continuously variable finger-protection

## Sportline

### RASOR manual cutting machines for sports field construction

Suitable for all common artificial turf

- developed for industrial cutting business
- high cutting performance at low service requirement
- semi-automatic push-button sharpening without removing knife



**Speedcut2**



**TT703 Turf Trimmer**

item code	description
<b>RASOR Sportline manual machines</b>	
<b>RATT703</b>	Battery shearsTurf Trimmer 703. 400V / 220V, max. cutting capacity: 20mm, 4-edge HSS blade Ø 70 mm (2,75") with hard-metal counterblade, 600-1000 U/min, 1,9kg incl. battery (6,0Ah Li-Ion)
<b>RASPEEDCUT</b>	Electrical shears Speedcut2, 150W / 220V, max. cutting capacity: 15mm, 4-edge HSS blade Ø 70 mm (2,75") with hard-metal counterblade, 750 U/min, 950g. 1,2kg

Ausstattung: Stahl-Bronze-Getriebe, halbautomatische Schleifeinrichtung, Floröffner

**GC ONE**



**GC Monster 2**



item code	description
<b>RASOR Sportline cutting units</b>	
<b>RAGC-MONSTER 2</b>	RASOR doppelte Akkuschneideinheit GreenCutter Monster2, 400W / 220V, 8-Bogen-Messer Ø 120mm (2") HSS-Stahl mit Hartmetall-Gegenschneide, Schneidhöhe bis 50mm, 600-1000 U/min, Gewicht 30kg
<b>RAGC-ONE</b>	RASOR Akkuschere GreenCutter ONE, 400W / 220V, 4-Bogen-Messer Ø 70mm (2,75") HSS-Stahl mit Hartmetall-Gegenschneide, Schneidhöhe bis 20mm, 600-1000 U/min, Gewicht 8,5kg incl. Akku (6,0Ah Li-Ion).

Ausstattung: Stahl-Bronze-Getriebe, halbautomatische Schleifeinrichtung, höhenverstellbarer Griff, Floröffner



## Pneumatic Shears

### RASOR pneumatic-shears line FP For carbon, glass-fibre and further technical textiles

- developed for industrial cutting business
- high cutting performance at low service requirement



**FP503**

**FP702**



item Code	description
<b>RASOR pneumatic shears</b>	
<b>RAFP503</b>	Pneumatic shears 350W / 6bar, max. cutting capacity 9mm, 6-edge knife Ø 50mm (1.96"), 1,900 rp/min, weight: 0.8kg
<b>RAFP702</b>	Pneumatic shears 380W / 6bar, max. cutting capacity 18mm, 4-, 6- or 10-edge knife Ø 70 mm (2.75"), 900 rp/min, weight: 0.92kg

Configuration of all pneumatic shears: bronze / steel coupling gear, semi-automatic push-button sharpening, double safety start-up system device, continuously variable finger-protection



## Pneumatic shears

### RASOR pneumatic shears FP503MT

For carbon, glass-fibre and further technical textiles

- developed for industrial cutting business
- MT = slim shape of front peak for edge trimming / mould trimming (**M**ould **T**rim)



item code	description
<b>RASOR pneumatic shears</b>	
<b>RAFP503MT</b>	Pneumatic shears 350W / 6bar, max. cutting capacity 9mm, 7-edge knife Ø 50 mm (1.96"), 1,900 rp/min, weight: 0.8kg, <b>Mould Trim</b> version for edge trimming / mould trimming

Configuration of all pneumatic shears: bronze / steel coupling gear, semi-automatic push-button sharpening, double safety start-up system device, continuously variable finger-protection

## Pneumatic Shears

### RASOR pneumatic-shears line FP For carbon, glass-fibre and further technical textiles

- developed for industrial cutting business
- high cutting performance at low service requirement

**FP862**



**FP862MT**



item Code	description
<b>RASOR pneumatic shears</b>	
<b>RAFP862</b>	Pneumatic shears 400W / 6bar, max. cutting capacity 25mm, 8-edge knife Ø 86 mm (3.4"), 1400 rp/min, weight: 1.1kg
<b>RAFP862MT</b>	Pneumatic shears 400W / 6bar, max. cutting capacity 25mm, 8-edge knife Ø 86 mm (3.4"), 1400 rp/min, weight: 1.1kg , <b>Mould Trim</b> , extra slim foot for cutting along the molded edge

Configuration of all pneumatic shears: bronze / steel coupling gear, semi-automatic push-button sharpening, double safety start-up system device, continuously variable finger-protection

## Pneumatic shears

### RASOR pneumatic-shears line FP For carbon, glass-fibre and further technical textiles

- developed for industrial cutting business
- high cutting performance at low service requirement
- central foot for cutting high-ply and rigid materials

**NEW**



item code	description
<b>RASOR pneumatic shears</b>	
<b>RAFP862M</b>	Pneumatic shears 400W / 6bar, max. cutting capacity 9mm, 8-edge knife Ø 86 mm (3.4"), 1400rp/min, weight: 0.8kg, blade in central position

Configuration of all pneumatic shears: bronze / steel coupling gear, semi-automatic push-button sharpening, double safety start-up system device, continuously variable finger-protection

## Rail systems

### RASOR rail systems and remote handles

#### For RASOR electric shears, pneumatic shears and cutting units

RASOR rail systems from solid Aluminium guarantee precise and straight cuts. The system usually is put into a notch, so the cutting material lays flat on the surface.

Main features: low wearing, low friction, oil-free maintenance, dust resistant, low weight and silenced operation.

Pre-drilled screw holes guarantee for fast installation

Remote handles can be installed for long cuts across the cutting table.

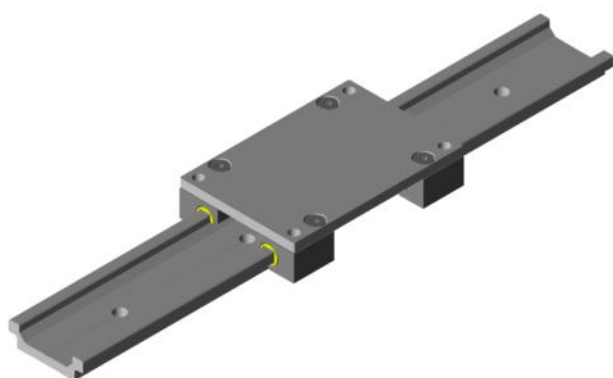

RARVG30-04 with RARVC30-04

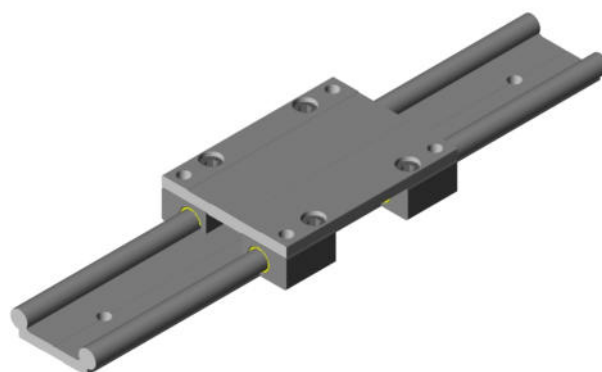

RARVG30-03 with RARVC30-03

item code	description
<b>RASOR rail systems</b>	
<b>RARVG030-04</b>	Aluminium rail series 0630 for all hand-operated machines of types: DS503, OPTIMA702, FP503, FP70, FP861 DS504, FP503, FP702, FP862, FP862M, Optima702/703
<b>RARVC030-04</b>	Train for rail-system RARVG030-04
<b>RARVG030-03</b>	Aluminium rail series 1040 for all machines with base plate (D, SW) and all cutting units (DD, GRT, SW)
<b>RARVC030-03</b>	Train for rail-system RARVG30-03
<b>RARVRHA1</b>	Remote handle 120cm with ON/OFF switch for machines with baseplates or OEM Series D & SW on rail system
<b>RARVRHA3</b>	Remote handle 170cm with ON/OFF switch for machines with baseplates or OEM Series D & SW on rail system
<b>RARVRHA2</b>	Remote handle 120cm with ON/OFF switch for handehld machines 50 and 70mm DS504 and Optima 702 / 703
<b>RARVRHA4</b>	Remote handle 170cm with ON/OFF switch for handehld machines 50 and 70mm DS504 and Optima 702 / 703





dal 1946

**RASOR OEM built-in units, series DD (Direct Drive)  
For technical textiles and films up to 50mm thickness**

## Built-in units



**DD120MR**



**DD120DT**

item code	description
Electrical built-in units / O.E.M. EINBAU DD – 3-phases 380V	
<b>RADD120MR</b>	Built-in unit 180W / 380V, 8-edge HSS knife, Ø 120mm, max. cutting capacity: 20mm, counter-blade WIDIA®, 2700 r.p.m
<b>RADD120ML</b>	Built-in unit 180W / 380V, 8-edge HSS knife, Ø 120mm, max. cutting capacity: 20mm, counter-blade WIDIA®, left-side-version (mirror version), 2700 r.p.m
<b>RADD120DT</b>	Built-in unit 180W / 380V, 8-edge HSS knife, Ø 120mm, max. cutting capacity: 20mm, counter-blade WIDIA®, bidirectional cut, 2700 rp/min

Configuration of all RASOR built-in units: bronze / steel coupling gear, semi-automatic push-button sharpening, continuously variable finger-protection.



## Built-in units

**RASOR OEM built-in units, series GRT (with gears)**  
**For technical textiles and Elastomeres up to 50mm thickness**

**GRT10**



**GRT10L**



item code	description
Electrical built-in units / O.E.M. – 3 phases 380V	
<b>RAGRT10</b>	Built-in unit 75W / 380V, max. cutting capacity 35mm, 6-edge-knife Ø 100 mm, 550 r.p.m
<b>RAGRT10L</b>	Built-in unit 75W / 380V, max. cutting capacity 35mm, 6-edge-knife Ø 100 mm, <b>left-side-version</b> (mirror version), 550 r.p.m

Special configuration: frequency converter at request.

All machines are also available with hard-metal coated knives and diamond sharpening-stone



**dal 1946**

## Built-in units

**RASOR OEM built-in units RASOR GRT (with gears).**  
**For heavy, technical textiles, rubber and films up to 50mm thickness**



**GRT12**

**GRT12DT**

bidirectional cutting system **GRT12DT**



item code	description
Electric built-in units / O.E.M. – 3 phases 380V	
<b>RAGRT12</b>	Built-in unit 180W / 380V, max. cutting capacity 50mm, 8-edge-knife Ø 120 mm, 400 r.p.m
<b>RAGRT12SX</b>	Built-in unit 180W / 380V, max. cutting capacity 50mm, 8-edge-knife Ø 120 mm, left-side-version (mirror version), 400 r.p.m
<b>RAGRT12DT</b>	Built-in unit 180W / 380V, max. cutting capacity 50mm, 8-edge-knife Ø 120 mm, bidirectional cut, 400 r.p.m

Special configuration: frequency converter at request.

All machines are also available with hard-metal coated knives and diamond sharpening-stone

## Built-in units

**RASOR OEM built-in units, series GRT (with gears)**  
For technical textiles and Elastomeres up to 25mm thickness



**GRT-MINI**



**GRT-MINIV**

item code	description
Electrical built-in units / O.E.M. – 3 phases 380V	
<b>RAGRT-MINI</b>	Built-in unit 55W / 380V, max. cutting capacity 25mm, 5-edge-knife Ø 86 mm, 550 r.p.m
<b>RAGRT-MINIV</b>	Built-in unit 55W / 380V, max. cutting capacity 25mm, 5-edge-knife Ø 86 mm, vertical motor, 550 r.p.m

Special configuration: frequency converter at request.

All machines are also available with hard-metal coated knives and diamond sharpening-stone

## Built-in units

**RASOR OEM built-in units RASOR GRT (with gears).**  
**for heavy, technical textiles, rubber and films up to 25mm thickness**

- developed for industrial cutting business
- high cutting performance at low service requirement
- central foot for cutting high-ply and rigid materials

**NEW**



back view cutting foot



item code	description
Electric built-in units / O.E.M. – 3 phases 380V	
<b>RAGRT-MINIVM</b>	Built-in unit 55W / 380V, 5-edge knife Ø 86 mm, max. cutting capacity: 25mm, vertical motor, 550 r.p.m

Special configuration: frequency converter at request.

All machines are also available with hard-metal coated knives and diamond sharpening-stone



## Built-in units

**RASOR OEM built-in units, series GRT (with gears) NEW**  
For technical textiles and Elastomeres up to 25mm thickness



item code	description
Electrical built-in units / O.E.M. – 3 phases 380V	
<b>RAGRT-Cross</b>	Built-in unit 55W / 380V, max. cutting capacity 25mm, 5-edge-knife Ø 86 mm, 550 r.p.m

Special configuration: frequency converter at request.

All machines are also available with hard-metal coated knives and diamond sharpening-stone





dal 1946



SCHNEIDTECHNIK  
Industrievertretung  
Handelsvertretung  
Consulting

## Built-in units

**RASOR OEM built-in units RASOR GRT Monster (with gears).**  
**Blade in central position for heavy, technical textiles, rubber and films**  
**up to 50mm thickness**

**GRT12M**



**GRT12SM  
left version**



item code	description
Electric built-in units / O.E.M. – 3 phases 380V	
<b>RAGRT12M</b>	Built-in unit 180W / 380V, 8-edge knife Ø 120 mm, 400 r.p.m
<b>RAGRT12SM</b>	Built-in unit 180W / 380V, 8-edge knife Ø 120 mm, left version (mirror version), 400 r.p.m

Special configuration: frequency converter at request.

All machines are also available with hard-metal coated knives and diamond sharpening-stone

## Built-in units

### RASOR OEM built-in units SW-series (with gears) For technical textiles and Elastomeres



**SW100S**



**SW12SM**

item code	description
Electric built-in units / O.E.M. – 1 phase 220V	
<b>RAD86PS2</b>	Built-in unit 90W / 220V, 5-edge knife Ø 86 mm, max. cutting capacity 25 mm, 850rp/min
<b>RASW100S</b>	Built-in unit 90W / 220V 6-edge knife Ø 100 mm, 850rp/min
<b>RASW10SL</b>	Built-in unit 90W / 220V 6-edge knife Ø 100 mm, 850U/min , left version (mirror version)
<b>RASW12S</b>	Built-in unit 180W / 220V 8-edge knife Ø 120 mm, max. cutting capacity 50 mm, 850 r.p.m
<b>RASW12SSX</b>	Built-in unit 180W / 220V 8-edge knife Ø 120 mm, max. cutting capacity 50 mm, left version (mirror version), 850r.p.m
<b>RASW12SM</b>	Built-in unit 350W / 220V 8-edge knife Ø 120 mm, max. cutting capacity 50 mm, blade in central position, 550rp/min
<b>RASW12SSM</b>	Built-in unit 350W / 220V 8-edge knife Ø 120 mm, max. cutting capacity 50 mm, blade in central position, 550rp/min, left version (mirror version)

Various frequencies / voltages / pneumatic versions and special equipment frequency converter at request. All machines are also available with hard-metal coated knives and diamond sharpening-stone

## Built-in units

**RASOR pneumatic built-in units FP series**  
**For Elastomeres, Carbon, glass fibres and further technical textiles**



**FP861A2**



**FP861V2**



**FP100**

item code	description
<b>RASOR pneumatic cutting units</b>	
<b>RAFP861V2</b>	Pneumatic shears 400W / 6bar, max. cutting capacity 25mm, 8-edge HSS-knife Ø 86 mm (3.4"), 900 rp/min, vertical turbine
<b>RAFP861A2</b>	Pneumatic shears 400W / 6bar, max. cutting capacity 25mm, 8-edge HSS-knife Ø 86 mm (3.4"), 900 rp/min
<b>RAFP100</b>	Pneumatic shears 400W / 6bar, max. cutting capacity 35mm, 8-edge HSS-knife Ø 100 mm (3.94"), 900 rp/min

Various frequencies / voltages / pneumatic versions and special equipment frequency converter at request. All machines are also available with hard-metal coated knives and diamond sharpening-stone

## Built-in units

**RASOR pneumatic built-in units FP series**  
**For Elastomeres, Carbon, glass fibres and further technical textiles**

**FP-CROSS**

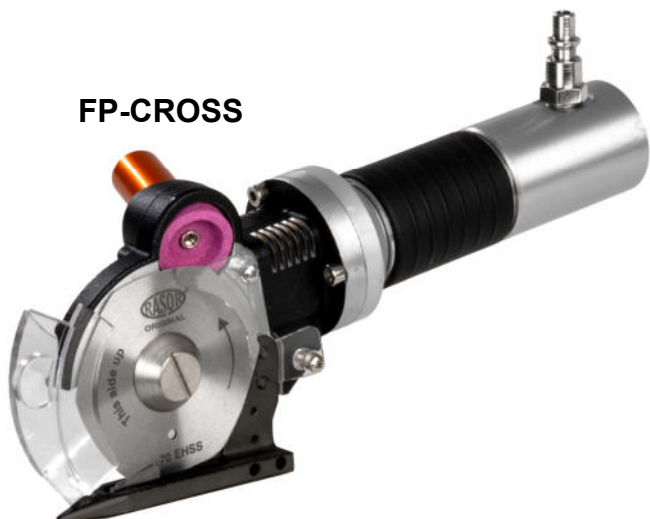

**NEW**



**FP120SM**

item code	description
<b>RASOR pneumatic cutting units</b>	
<b>RAFP-Cross</b>	Pneumatic shears 380W / 6bar, max. cutting capacity 18mm, 6-edge HSS-knife Ø 70 mm (2.75"), 1300 rp/min
<b>RAFP120M</b>	Pneumatic shears 800W / 6bar, max. cutting capacity 50mm, 8-edge HSS-knife Ø 120 mm (4.7"), central foot position, 700 rp/min
<b>RAFP120SM</b>	Pneumatic shears 800W / 6bar, max. cutting capacity 50mm, 8-edge HSS-knife Ø 120 mm (4.7"), central foot position, 700 rp/min, left (mirror version)

All RASOR-Built-in-units are equipped with semi-automatic sharpening device and various finger-protection



## Razor blades

item code	Ø mm	description
<b>Ø 50mm</b>		
RALA50CHSS	50	Round knife, HSS-steel
RALA503EEXT	50	6-edge knife, XXX EXTRA-steel
RALA503EHSS	50	6-edge knife, HSS-steel
RALA503EHSSTF	50	6-edge knife, HSS-steel, Teflon®-coated
RALA503DHSS	50	10-edge knife, HSS-steel
<b>Ø 70mm</b>		
RALA70CHSS	70	Round knife, HSS-steel
RALA70SHSS	70	4-edge knife, HSS-steel
RALA70SHSSTF	70	4-edge knife, HSS-steel, Teflon®-coated
RALA70EHSS	70	6-edge knife, HSS-steel
RAWI70EMD	70	6-edge knife, WIDIA®
RALA70EHSSTF	70	6-edge knife HSS-steel, Teflon®-coated
RALA70DHSS	70	10-edge knife, HSS-steel
RALA70DHSSTF	70	10-edge knife, HSS-steel, Teflon®-coated
<b>Ø 86mm</b>		
RALA86CEXT	86	Round knife, XXX WS-steel
RALA86CSHSS	86	Round knife, HSS-steel
RALA86PHSS	86	5-edge knife, HSS-steel
RALA86PHSSTF	86	5-edge knife, HSS-steel, Teflon®-coated
RALA86TSHSS	86	8-edge knife, HSS-steel
RALA86TSHSSTF	86	8-edge knife, HSS-steel, Teflon®-coated
RALA86THSSTN	86	8-edge knife, HSS-steel, XXX TiN-beschichtet
RAWI86TMD	86	8-edge knife, WIDIA®
<b>Ø 100mm</b>		
RALA10CEXTG	100	Round knife, XXX WS-steel
RALA10CGHSS	100	Round knife, HSS-steel
RALA10SEXTG	100	4-edge knife, XXX WS-steel
RALA10EHSS	100	6-edge knife, HSS-steel
RALA10EHSSTF	100	6-edge knife, HSS-steel, Teflon®-coated
RAWI10EMD	100	6-edge knife, WIDIA®
<b>Ø 120mm</b>		
RALA12CSW	120	Round knife XXX WS-steel
RALA12SHSS	120	8-edge knife, HSS-steel
RALA12SHSSTN	120	8-edge knife, HSS-steel, XXX TiN-coated
RALA12SHSSTF	120	8-edge knife, HSS-steel, Teflon®-coated
RAWI12SMD	120	8-edge knife, WIDIA®
RALA12DHSS	120	12-edge knife, HSS-steel

More than 125 years ago, Eastman introduced the first electric cloth-cutting machine, which allowed the clothing industry to evolve from the manual drudgery of cutting to a modern operation. Today, the company continues to deliver engineering-based solutions that make real differences to facilities using new and high-tech materials as well as traditional textiles.

As a fifth-generation, family-operated business, Eastman is devoted to excellence. Our promise to craft reliable, quality, American-made solutions means that your Eastman product is guaranteed to perform and ensure your production requirements are realized. With our excellent reputation built into every machine, you can rest assured knowing you're not just buying a product — you're partnering with a team dedicated to your productivity and performance.

## Manual cutting machines

Eastman's product range contains straight- and round-knife-machines rotary shears and end cutters. They enable small and large companies to produce efficiently. Our team of specialists will assist you to find your cutting solution for cutting cotton, nylon, carbon-fibres, glass-fibres, Kevlar, Cordura®, linen, foamed material and many further materials.

## Automatic cutting (CNC)

Eastman's automatical single- and multi-ply- cutting systems are developed for a number hightec materials. Those materials are used in industries of composites, aviation, technical textiles and clothing. Eastman's systems are cutting reliably and precisely up to a  $\frac{1}{100}$  mm of tolerance. An excellent nesting software enables the maximum utilisation of material and minimises your waste.

Eastman developed unique cutting solutions, which are outstanding in the cutting technology. Even heavy materials like polystyrene, vinyl, p-tex and fiberglass / Polyester mixes can be cut.

The Eastman cutting systems are compatible with most common softwares. Our qualified technic-service are able to care and operate your system.

Eastman machines are developed in co-operation with our customers, we are your partner for access to Eastman technics to solve your cutting problems.



## Feeding and spreading

Eastman-systems are the best solution for efficient feeding with precise edge-positions control. They offer automatic as well as manual operated feeding systems, which are suitable for many different materials from light to very heavy fabric rolls. Many of their systems can be set up for different fabric weights.

With Eastmans automatic feeding systems, various sorts of fabrics can be forwarded to the cutting table - including precise edge-position control.





# Eagle S125 Static Table Cutting System

**Eastman®**



## Go ahead. Get tough.

Eastman's static table system is capable of cutting, marking, drilling and punching virtually any flexible material at speeds of up to 60 inches per second (152.4 cm/sec.). The static cutting table has proven itself as the go-to resource for materials like cotton, nylon and vinyl as well as difficult-to-cut materials—such as polystrand, p-tex, and fiberglass-polyester blends. The static table system is available in a range of system lengths and widths to meet the demands for prototypes, one-offs and full-production runs. The system's high-precision configuration features multi-axis motion for more defined and accurate cuts. Material is spread across the static table by an operator or with the use of a pneumatic gripper bar. The open plenum vacuum system design ensures evenly dispersed airflow for optimal material hold-down. This computer-controlled system features zoning capabilities to enable cutting in one area while the operator is simultaneously picking parts in another, maximizing daily production capacity.

### Cutting Surface

The standard cutting surface is a porous plastic sheet. Alternative cutting surfaces are available to optimize cutting results for any given material or aid in controlling material contamination concerns. Proven reliable for 2,000+ hours of normal operation use.

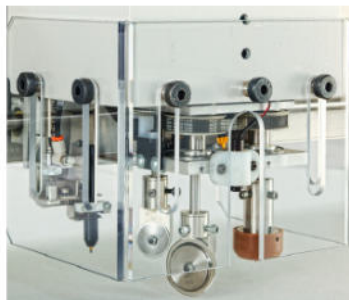

### Material Hold-Down

The S125 is equipped with a high-flow vacuum system to ensure optimum material hold-down for cutting. The porous surface ensures evenly dispersed vacuum flow, no matter where you are cutting. Cutting zones may be designated so that cutting occurs in one area while piece removal takes place in another.

### International Compliance Ratings

The operating computer and control cabinet are housed in an ergonomic enclosure that can be sealed to offer dust and water resistant protection in harsh or high particulate environments. Additionally, cabling connectors, servo motors and display components meet recognized international protection ratings requirements.

### Made to Order

Available in a range of widths, lengths and various tool head accessory options, the S125 will be built to match your application needs, allowing you to customize the tools and capabilities to maximize productivity.

### Industrial Design for Rigorous Use

- Advanced electro-pneumatic regulator for precise tool pressure control
- Heavy-duty cable connectors
- Easy access, sealed doors for inspection and maintenance
- Heavy-gauge steel construction with scratch-resistant powder coated finish



**sales representative  
for central Europe**

**RH Schneidtechnik - Neuenhofer Str. 75 - D-42657 Solingen / Germany**  
**Phone: +49 (0) 212 / 2354300 - fax: +49 (0)212 / 2354301**  
**Email: [info@rh-schneidtechnik.de](mailto:info@rh-schneidtechnik.de)**  
**[www.rh-schneidtechnik.de](http://www.rh-schneidtechnik.de)**



# Eastman®

## Safety

- Four remote emergency stops: two on cutting gantry, two system-mounted
- Additional gantry-mounted stop disks pause system operation until returned to neutral and reset. Operation can then be resumed from any position
- Tool head is equipped with plexiglass safety window to keep hands free of knife during operation
- Single turn-off point with a universal power system for lockout/tagout safeguards employees from unexpected start-up

## Options

### Additional Solutions

- **LabelPRO** | adhesive label system
- **EasiMark** | airbrush marking system
- **JetPRO** | drop-on-demand inkjet
- **EasiPull** | material pulling system
- **Fiber tool head**
- **Heavy-Duty tool head**
- **Router tool head**
- **Laser tool head**

## Flexible Design

### Tool Head

Choice of standard, heavy-duty or fiber tool head, featuring individually aligned and calibrated tool spindles with your choice of over 60 blades, punches and notches.

A library feature within the operating control software allows the operator to save commonly used tool pressures and blade assignments based on job and material files.

Prevent unauthorized changes to the system and software with restricted login access.



### Marking/Labeling

All tool heads are equipped with a pen or Sharpie® assembly for marking. Additional options available for airbrush ink spray, adhesive labels or drop-on-demand inkjet.

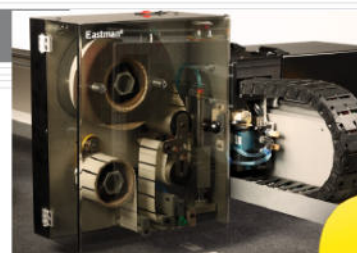

## Static Cutting Table Technical Specifications\*

BASIC SPECIFICATIONS*		ENGLISH	METRIC
Please contact the factory for active cutting zone dimensions. Custom widths and lengths available.	Width	54 in.	1.37 m
		60 in.	1.54 m
		72 in.	1.82 m
		78 in.	1.98 m
		96 in.	2.44 m
		108 in.	2.74 m
		114 in.	2.90 m
		126 in.	3.20 m
		156 in.+	3.96 m+
	Length	8 ft.	2.44 m
12 ft.		3.66 m	
16 ft.		4.88 m	
20 ft.		6.10 m	
36 ft.+		10.97 m	
Drive System		Dual-X Axis, Y-Axis & Theta Axis. X & Y-Axis Rack & Pinion Drive, Brushless Servo Motors	
POWER REQUIREMENTS			
Electric	Diagnostic Control Cabinet/PC	230V, 3 ph, 50/60 Hz, 5.4 kVA. Stand-alone step-down transformer required for other voltages.	
	Vacuum Blower	208/230/380/460V, 3 ph, 50/60 Hz, 7.5 HP, VFD control optional	
Pneumatic		75 – 90 psi at 15 SCFM	5.17 – 6.2 bars at 0.42 cmm
SPEEDS			
Maximum Cutting Speed		60 in./sec.	152.4 cm/sec.
Maximum Acceleration		1.3 g	
Maximum X/Y Speed		60 in./sec.	
ENVIRONMENTAL			
Compressed Air Consumption		15 CFM	
Sound Level		<76 dB(A)	
Operating Temperature		55 – 100°F	12 – 37°C
Humidity		20 – 80% (non-condensing)	

\*Achievable speeds and accelerations are tool, material and thickness dependent. All indicated speeds, dimensions, weights and performance data are approximate and subject to change without notice.



**sales representative  
for central Europe**

**RH Schneidtechnik - Neuenhofer Str. 75 - D-42657 Solingen / Germany**  
**Phone: +49 (0) 212 / 2354300 - fax: +49 (0)212 / 2354301**  
**Email: info@rh-schneidtechnik.de**  
**www.rh-schneidtechnik.de**



## Taking continuous cutting to new heights

The **Eagle™ C125 conveyor system** has supreme capabilities for single- to low-ply cutting requirements. It has the ability to continuously convey rolled material goods with consistent speed and control. Eastman's gantry and tool-head design are engineered to cut the most diverse technical and industrial fabrics available, while exceeding industry standards for accuracy. The robust conveyor design delivers unrivaled levels of material utilization and is often capable of cutting multiple layers without plastic overlay\*. This computer-controlled cutting system requires minimal operator guidance to automatically feed and spread material to the identified start position. Smooth and accurate cutting of long markers is accomplished with the support of a powerful, yet quiet and self-contained vacuum system.

### Cutting Surface

The cutting surface is a smooth and durable, high-durometer cast urethane conveyor belt suitable for even sticky or downy materials. It has proven reliable for 2,000+ hours of normal operation, with some customers testifying to more than four years of continuous use.

### Material Hold-Down

The C125 is equipped with a self-contained, high-flow vacuum system to ensure optimum material hold-down for cutting. Millions of holes are perforated in a random pattern that provides evenly dispersed vacuum flow, no matter where you are cutting. The piece removal zone is integrated into the design, eliminating the need for extension tabling.

### Made to Order

Available in a range of widths, lengths and various tool head accessory options, the C125 will be built to match your application needs, allowing you to customize the tools and capabilities to maximize productivity.

### International Compliance Ratings

The operating computer, and control cabinet are housed in independent enclosures that are sealed to offer dust and water resistant protection in harsh or high particulate environments. Additionally, cabling connectors, servo motors and display components meet recognized international protection ratings requirements.



### Industrial Design for Rigorous Use

- Advanced electro-pneumatic regulator for precise tool pressure control
- Built-in surge protection to block voltage spikes and surges
- Heavy-duty cable connectors
- Hi/Low voltage systematic panel layout for easy troubleshooting
- Easy access, sealed doors for inspection and maintenance
- Heavy-gauge steel construction with scratch-resistant powder coated finish

\*Material dependent



**sales representative  
for central Europe**

**RH Schneidtechnik - Neuenhofer Str. 75 - D-42657 Solingen / Germany**  
**Phone: +49 (0) 212 / 2354300 - fax: +49 (0)212 / 2354301**  
**Email: [info@rh-schneidtechnik.de](mailto:info@rh-schneidtechnik.de)**  
**[www.rh-schneidtechnik.de](http://www.rh-schneidtechnik.de)**



# Eastman®

## Safety

- Four remote emergency stops: two on cutting gantry, two system-mounted
- Additional gantry-mounted stop disks pause system operation until returned to neutral and reset. Operation can then be resumed from any position
- Tool head is equipped with plexiglass safety window to keep hands free of knife during operation
- Single turn-off point with a universal power system for lockout/tagout safeguards employees from unexpected start-up



## Flexible Design

### Tool Head

Choice of standard, heavy-duty or fiber tool head, featuring individually aligned and calibrated tool spindles with your choice of over 60 blades, punches and notches.

A library feature within the operating control software allows the operator to save commonly used tool pressures and blade assignments based on job and material files.



### Marking/Labeling

All tool heads are equipped with a pen or Sharpie® assembly for marking. Additional options available for airbrush ink spray, adhesive labels or drop-on-demand inkjet.



## Options

### Additional Solutions

- EasiHold® | for cutting lofted material
- EasiLabel | adhesive label system
- EasiMark | airbrush marking system
- JetPRO | drop-on-demand inkjet
- Variety of material handling equipment
- Fiber tool head
- Heavy-Duty tool head

## Conveyor Technical Specifications\*

BASIC SPECIFICATIONS*		ENGLISH	METRIC
Please contact the factory for active cutting zone dimensions. Custom widths and lengths available.	Width	78 in.	1.98 m
		96 in.	2.44 m
		108 in.	2.74 m
		114 in.	2.90 m
		126 in.	3.20 m
	Length	156 in.	3.96 m
		12 ft.	3.66 m
		16 ft.	4.88 m
	20 ft.	6.10 m	
	36 ft.	10.97 m	
	Drive System		Dual-X Axis, Y-Axis & Theta Axis. X & Y-Axis Rack & Pinion Drive, Brushless Servo Motors
POWER REQUIREMENTS			
Electric	Diagnostic Control Cabinet/PC	230V, 3 ph, 50/60 Hz, 5.4 kVA. Stand-alone step-down transformer required for other voltages.	
	Vacuum Blower	208/230/380/460V, 3 ph, 50/60 Hz, 10 HP, VFD control	
Pneumatic		75 – 90 psi at 15 SCFM	5.17 – 6.2 bars at 0.42 cmm
SPEEDS			
Maximum Cutting Speed		60 in./sec.	152.4 cm/sec.
Maximum Conveyor Speed (System size dependent)		11 in./sec.	28 cm/sec.
Maximum Acceleration		1.3 g	
Maximum X/Y Speed		60 in./sec.	
ENVIRONMENTAL			
Compressed Air Consumption		15 CFM	
Sound Level		<76 dB(A)	
Operating Temperature		55 – 100°F	12 – 37°C
Humidity		20 – 80% (non-condensing)	

\*Achievable speeds and accelerations are tool, material and thickness dependent. All indicated speeds, dimensions, weights and performance data are approximate and subject to change without notice.



sales representative  
for central Europe

RH Schneidtechnik - Neuenhofer Str. 75 - D-42657 Solingen / Germany  
Phone: +49 (0) 212 / 2354300 - fax: +49 (0) 212 / 2354301  
Email: [info@rh-schneidtechnik.de](mailto:info@rh-schneidtechnik.de)  
[www.rh-schneidtechnik.de](http://www.rh-schneidtechnik.de)

## Feeding systems

### Eastman offers various feeding systems:

- Faster flow because of automatic material transport
- Low need of operation
- Space-saving
- Clean storage of cutting material

**3-roll-feeding  
system  
CRA-355**



**A-roll-rack**



**multi-roll-rack  
with paternoster elevator**



Feeding systems need to be manufactured at your system requires. Please give us following information to receive your personal offer:

- |                            |                 |
|----------------------------|-----------------|
| • required number of rolls | • roll-weight   |
| • width of rolls           | • roll-diameter |



## Eastman-spare blades for CNC-Systems

Item-Code		
EA54-26011-10		EASTMAN Drag Knife Blade 30°, 10-pcs. unit
EA54-26011-3-10		EASTMAN Drag Knife Blade 45°, 10-pcs. unit
MEEAC280-10		EASTMAN Spare blade 28mm, 10-pcs. unit
MEEAC450-10		EASTMAN Spare blade 45mm, 10-pcs. unit



## Straight knife cutting machines



### **EASTMAN Blue Streak II®** **Class 629 straight knife cutting machine**

- The world's most popular and most versatile straight knife cutting machine.
- Available in all standard electrical configurations, with the largest variety of sizes and blade speeds in the industry (680W, optional 220V or 380V)
- Weight: 15.4kg



### **EASTMAN Brute®** **Class 627 straight knife cutting machine**

- Most powerful straight knife cutting machine manufactured in the world for composites- and textile industry
- effortlessly powers through high ply applications and heavy weight materials.
- Available in 1600W, optional 220V or 380V
- Weight: 16.7kg

item code	description
Eastman straight knife cutting machines	
<b>EABLUESTREAK6</b>	EASTMAN BLUE STREAK II Class 629 X 6", max. cutting capacity 11.4 cm
<b>EABLUESTREAK8</b>	EASTMAN BLUE STREAK II Class 629 X 8", max. cutting capacity 16.5 cm
<b>EABLUESTREAK10</b>	EASTMAN BLUE STREAK II Class 629 X 10", max. cutting capacity 21.5 cm
<b>EABLUESTREAK13</b>	EASTMAN BLUE STREAK II Class 629 X 13", max. cutting capacity 29.0 cm
<b>EABRUTE6</b>	EASTMAN BRUTE Class 627 X 6", max. cutting capacity 11.4 cm
<b>EABRUTE8</b>	EASTMAN BRUTE Class 627 X 8", max. cutting capacity 16.5 cm
<b>EABRUTE10</b>	EASTMAN BRUTE Class 627 X 10", max. cutting capacity 21.5 cm
<b>EABRUTE13</b>	EASTMAN BRUTE Class 627 X 13", max. cutting capacity . 29.0 cm

Included in all machines: automatic sharpening unit, easy-gliding baseplate.

Optional: auto-stop option, dual speed (1500/3000rpm), additional heights

## Round knife machines



### **EASTMAN Cardinal® Class 548 round knife machine**

- Unrequaled quality and long-lasting in industrial textile manufacturing
- Very suitable for cutting higher stacks of textiles and fleece

### **EASTMAN Cardinal® round knife machine Heavy Duty 562 / Super Duty 567**

- Unrequaled quality and long-lasting in industrial textile manufacturing
- With double gear
- Very suitable for cutting higher stacks of textiles and fleece
- Optional: dual speed (1500 & 3000 rounds / minute)



item code	description
<b>Eastman round knife machines</b>	
<b>EACD548X52</b>	EASTMAN Standard Class 548 X 5.25" (13.3cm), 1500 or 2850 rp/min, max. cutting capacity 7.9cm, weight 9.52kg
<b>EACD548X6</b>	EASTMAN Standard Class 548 X 6" (15.2cm), 1500 or 2850 rp/min, max. cutting capacity 9.0cm, weight 9.6kg
<b>EAHD562X6</b>	EASTMAN Heavy Duty Class 562 X 6" (15.2cm), machine capacity 570W / 220V, 1500 or 3000 rp/min, max. cutting capacity 8,2cm, weight 13.6kg
<b>EAHD562X75</b>	EASTMAN Heavy Duty Class 562 X 7,5 (19,1cm), machine capacity 680W / 380V, 1500 or 3000 rp/min, max. cutting capacity 12.0cm, weight 13.6kg
<b>EASD567X6</b>	EASTMAN Super Duty Class 567 X 6" (15.2cm), machine capacity 920W / 220V, 1500 or 3000 rp/min, max. cutting capacity 8.2cm, weight 16.3kg
<b>EASD567X75</b>	EASTMAN Super Duty Class 567 X 7,5" (19,1cm), machine capacity 1600W / 380V, 1500 or 3000 rp/min, max. cutting capacity 12.0cm, weight 16,3kg

All machines include a semi-automatic sharpening unit and easy-gliding baseplate.

## Round knife machines

### **EASTMAN Cardinal® Class 548 round knife machine**

- blade in central position
- very suitable for inflexible material like carpets and floor coverings



### **EASTMAN Cardinal® round knife machine**

#### **Heavy Duty 562BK/ Super Duty 567BK**

- Unrequaled quality and long-lasting in industrial textile manufacturing
- blade in central position
- very suitable for inflexible material like laminated material, carpets and floor coverings
- Optional: Dual Speed 1500 & 3000 rp/min.



item code	description
<b>Eastman round knife machines</b>	
<b>EACD548X5BK</b>	EASTMAN Slitter Class 548 X 5" (12,5cm), 1500U/min, Schneidhöhe max. 2,5cm , 10kg
<b>EACD548X5CC</b>	EASTMAN Carpet Cutter Class 548 X 5"(12,5cm), 1500U/min, Schneidhöhe max. 2,5cm, 7,3kg
<b>EAHD562X75BK</b>	EASTMAN Heavy Duty Class 562 X 7,5" (19,1cm), 680W / 380V, 1500 oder 3000U/min, Schneidhöhe max. 5,2cm, 13,6kg
<b>EASD567X75BK</b>	EASTMAN Super Duty Class 567 X 7,5" (19,1cm), 1600W / 380V, 1500 oder 3000U/min, Schneidhöhe max. 5,2cm, 16,3kg

All machines include a semi-automatic sharpening unit and easy-gliding baseplate.





**EASTMAN Falcon IV to 548HD**  
**models FAL-4, FAL-AIR, 534-548HD**  
rail-guided manual cutting machine for perfect, straight cuts

- reliable, multifunctional and user-friendly
- stabilizers in the rail ensure safe cuts even when cutting over 1.82m

## **EASTMAN Auto Track Falcon II** **models ATF-II & ATF-IIP**

rail-guided manual cutting machine for perfect, straight cuts

- faster cycling thanks to automatic cutting
- reliable, multifunctional and user-friendly
- torque-optimized transmission
- stabilizers in the rail ensure safe cuts even when cutting over 1.82m



item code	description
Eastman round knife machines	
<b>EAATF-II</b>	EASTMAN Auto-Track Falcon II, with 80" (ca. 200cm) rail system
<b>EAATF-II-P</b>	EASTMAN Auto-Track Falcon II, <b>pneumatic</b> , with 80" (ca. 200cm) rail system
<b>EAFAL-IV</b>	EASTMAN Falcon IV, with extension handle, rail (180cm) and lifter
<b>EAFAL-IV-1</b>	EASTMAN Falcon IV, with extension handle

The Falcon cutting systems are customized to your requirements, please give us following information:

- width of your cutting table
- need extension handle?

## Special purpose machines

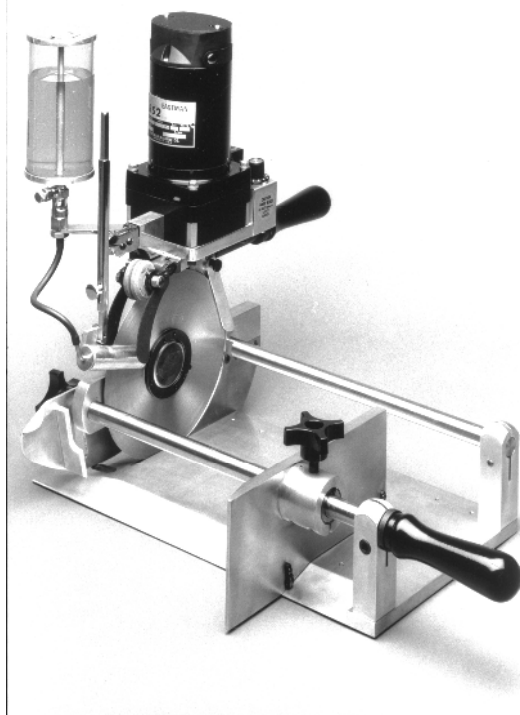

### EASTMAN RUBBER SLITTER

#### Model RS2

Engineered to cut very dense rubber and plastic sheeting up to 50mm thickness

- high torque motor
- Adjustable knife speed 0-50 turns/min
- Optional with baseplate and / or strip gauge
- Incl. knife lubricator



### EASTMAN RAG CUTTER

#### Model WE

Rag cutter for recycling textiles

f. e. for making rags, disposable wipes and towels

- built-in button remover
- built-in sharpener
- telescopic height adjustment
- Available in single or dual workstation models
- Adaptable to many materials and applications

item code	description
<b>Eastman special applications</b>	
<b>EARS2</b>	EASTMAN Rubber Slitter 7.5" (19.1cm), 1300W / 220V, rubber cutter for very dense rubber and plastic sheeting, weight: 9.12kg
<b>EARAGCUTTERWE</b>	EASTMAN Rag Cutter WE 6" (15.2cm) textile cutter for application of old textiles, double-arm-version
<b>EARAGCUTTERWE-1</b>	EASTMAN Rag Cutter WE 6" (15.2cm) textile cutter for application of old textiles, single-arm-version

## Eastman-blades for manual machines

### Item code

	<b>For straight knife cutting machines</b>
<b>MEEASTMAN6HSS12</b>	<b>Straight knife EASTMAN 6", 12-pcs.-pack</b>
<b>MEEASTMAN6WHSS12</b>	<b>Wave knife EASTMAN 6", 12-pcs.-pack</b>
<b>MEEASTMAN8HSS12</b>	<b>Straight knife EASTMAN 8", 12-pcs.-pack</b>
<b>MEEASTMAN8WHSS12</b>	<b>Wave knife EASTMAN 8", 12-pcs.-pack</b>
<b>MEEASTMAN10HSS12</b>	<b>Straight knife EASTMAN 10", 12-pcs.-pack</b>
<b>MEEASTMAN10WHSS12</b>	<b>Wave knife EASTMAN 10", 12-pcs.-pack</b>
<b>MEEASTMAN13HSS12</b>	<b>Straight knife EASTMAN 13", 12-pcs.-pack</b>
<b>MEEASTMAN13WHSS12</b>	<b>Wave knife EASTMAN 13", 12-pcs.-pack</b>
	<b>For round knife cutting machines</b>
<b>MEEACARDINAL525WS</b>	<b>round knife type EASTMAN Cardinal 5,25, WS</b>
<b>MEEACARDINAL6WS</b>	<b>round knife type EASTMAN Cardinal 6", WS</b>
<b>MEEACARDINAL75WS</b>	<b>round knife type EASTMAN Cardinal 7,5" WS</b>

# Under construction

NEW @ RH Schneidtechnik: **elaxa®** Hightech—Battery-Shars

For technical textiles like fiberglass, carbon fiber and Aramid



item code	description
<b>RH elaxa® battery shears</b>	
<b>ELAXA-Standard 01</b>	<b>elaxa®-Standard Battery shears</b> 150W, 14.1V Li-Ion battery 3.1Ah, blades HSS-Steel, HRC62.0, upper blade <b>linear</b>
<b>ELAXA-XL 01</b>	<b>elaxa®-XL Battery shears</b> 400W, 14.1V Li-Ion battery 6.2Ah, blades HSS-Steel, HRC62.0, upper blade <b>linear</b>
<b>ELAXA-Standard 02</b>	<b>elaxa®-Standard Battery shears</b> 150W, 14.1V Li-Ion battery 3.1Ah, blades HSS-Steel, HRC62.0, upper blade <b>radial</b>
<b>ELAXA-XL 02</b>	<b>elaxa®-XL Battery shears</b> 400W, 14.1V Li-Ion Battery 6.2Ah, blades HSS-Steel, HRC62.0, upper blade <b>radial</b>
<b>ELAXA-PCS</b>	<b>elaxa</b> PC-front protection complete, high adjustable

**Technical data:** Motor: 150W (XL 400W), brushless  
Cutting cap. max.: 8mm (XL 12mm)  
Cutting speed up to: 20m/min  
Battery: 14.1V Li-Ion, Working time: approx. 8h/charging  
Length: 280mm (XL 320mm), Handle Ø 56mm  
Weight: 0.85kg (XL 1.1kg)

**More options:** Blade speed 2000rpm (Standard), 1000rpm, 4000rpm

**ELAXA front protection adjustable**

**ELAXA in fiberglass 1700g/m²**



# Battery shears

**ELAXA front protection  
adjustable**



**ELAXA in fiberglass 1700g/m²**



**elaxa®-Upper blade linear**



**elaxa®-Upper blade radial**

Material to cut	Blade selection Upper blade				
	Linear	Radial 45° HSS	Radial 15° HSS	Radial 45° carbide	Radial 15° carbide
Fiberglass	+++	+++	++	+++	
Carbon fiber		++	++	+++	++
Aramid			++		+++
Zylon® / Dyneema®					+++
Cardboard	+++	+++	++		
PVC / Rubber/ Leather	+++	+++			
Felt / Fleece / Carpet	++	+++			

**Recommendation:** micro-serrated bottom blades for loose fiberglass and carbon fiber, Aramid, Zylon® und Dyneema®

## NEW @ RH Schneidtechnik: **elaxa®** HIGH-TEC OEM Cutting Unit

For Technical Textiles like glass fiber, carbon fiber and Aramid



Side view



Front view

item code	description
<b>RH elaxa®- Cutting Unit</b>	
<b>ELAXA-EBG 02</b>	<b>elaxa®-Standard Cutting Unit</b> 150W, 14.1V blades HSS-Steel, HRC62.0, upper blade <b>radial</b> , <b>2000rpm</b>
<b>ELAXA-EBG 02-1</b>	<b>elaxa®-Standard Cutting Unit</b> 150W, 14.1V blades HSS-Stahl, HRC62.0, upper blade <b>radial</b> , <b>1000rpm</b>
<b>ELAXA-EBG-NT</b>	<b>elaxa®- power supply incl. connection for ELXA-EBG</b>
<b>ELAXA-PCS</b>	<b>elaxa</b> Finger protection complete, high adjustable

**Technical data:** Motor: 150W brushless  
Cutting capacity max.: 8mm (ca. 5000g/m<sup>2</sup>)  
Cutting speed max.: 20m/min

Length: 150mm, width: 65mm, height incl. holder 175mm  
Weight: 0.95kg

**options:** RPM. 2000rpm (Standard-version), 1000rpm, variable

## Cutting unit

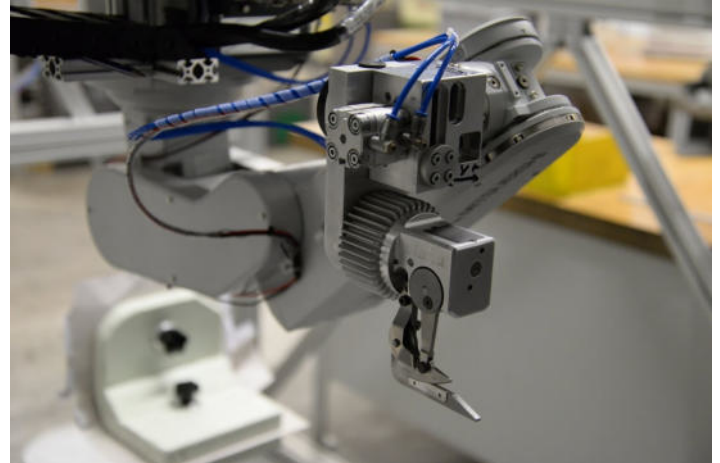
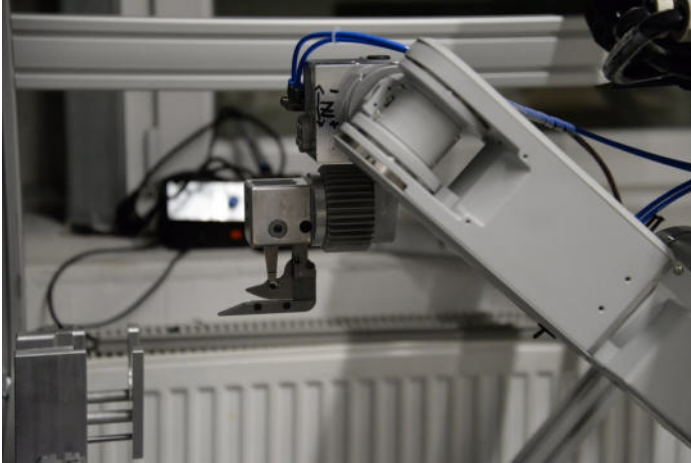

ELAXA-EBG on robot



**elaxa®**-Upper blade linear



**elaxa®**-Upper blade radial

Material to cut	Blade selection Upper blade				
	Linear	Radial 45° HSS	Radial 15° HSS	Radial 45° carbide	Radial 15° carbide
Fiberglass	+++	+++	++	+++	
Carbon fiber		++	++	+++	++
Aramid			++		+++
Zylon® / Dyneema®					+++
Cardboard	+++	+++	++		
PVC / Rubber/ Leather	+++	+++			
Felt / Fleece / Carpet	++	+++			

## Pneumatic shears

### Pneumatic shears RH COMPOSITE-MAX, MAX-S and SLIM

For composites, synthetics, resins, rubber and metals



RH-Composite-Max



RH-Composite-Slim

item code	description
<b>RH pneumatic shears</b>	
<b>RHCOMPOSITEMAX</b>	Pneumatic Shears RH COMPOSITE-MAX, Cutting head made from forged alloyed tool steel, Hardness: HRC62.0
<b>RHCOMPOSITEMAXS</b>	Same as above but with short cutting head for cutting radii.

Technical data: consumption 450l/min at 6.3bar, cutting speed up to: 20m/min, cutting capacity up to: 2.5mm, Weight: 1.5kg

<b>RHCOMPOSITESLIM</b>	Pneumatic Shears RH COMPOSITE-SLIM Cutting head made from forged alloyed tool steel, Hardness: HRC62.0
<b>RHCOMPOSITESLIMS</b>	Same as above but with short cutting head for cutting radii.

Technical data: consumption 300l/min at 6,3bar, cutting speed up to: 12m/min cutting capacity up to 2.0mm, sheet steel: 0.6mm, weight: 0.7kg



## Pneumatic shears

### Pneumatic shears RH TECHTEX-MAX and TECHTEX-SLIM für technical textiles as Carbon, glass fibre and aramid



RH TECHTEX-MAX

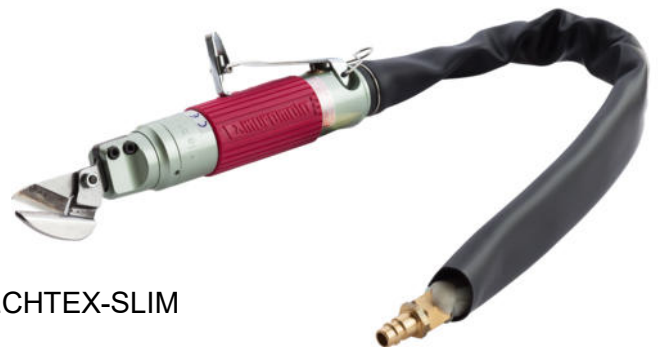

RH TECHTEX-SLIM

item code	description
RH pneumatic shears	
RHTECHTEXMAXHMSE	Pneumatic shears RH TECHTEX-MAX-HMSE with <b>carbide-metal</b> -equipped cutting head. One blade <b>micro-serrated</b> for fast cutting. <b>Applications: aramid, Dyneema®, Zylon® and carbon fibres</b>
RHTECHTEXMAXHM	As above, with <b>carbide-metal</b> -equipped cutting head, without micro-serration. <b>Applications: carbon- and glass fibres</b>
RHTECHTEXMAXWS2xSE	As above, with <b>carbide-metal</b> -equipped cutting head, both blades <b>micro-serrated</b> . <b>Application: glass-fibres</b>

Consumption: 450l/min at 6.3bar, cutting speed: max. 20m/min  
Max. cutting capacity: 15mm, weight: 1.5kg

RHTECHTEXSLIMHM	Pneumatic shears RH TECHTEX-SLIM <b>carbide-metal</b> -equipped cutting head
RHTECHTEXSLIM	Pneumatic shears RH TECHTEX-SLIM with <b>HSS-steel</b> cutting head, both blades <b>micro-serrated</b> for fast cutting

Consumption: 300l/min at 6.3bar, max. cutting speed: 12m/min,  
Max. cutting capacity: 6mm, weight: 0.7kg

## Rubber cutter

### RH rubber cutter series RHGS-500

- With round knife for tight tolerant, straight cuts
- materials: rubber (shore-hardness A 40-90°), conveyor belts, PVC, carton, leather, felt-, fibre- and sealing materials
- Max. cutting capacity 50mm, up to 1000mm cutting width



**RH rubber cutter P500, with round knife**

item code	description
RH rubber cutter	
<b>RHGS500-2</b>	<b>RHGS-P500-2</b> with round knife For straight cuts in rubber, PVC, carton etc. <u>Technical data:</u> Max. cutting width: <b>1000mm</b> Cutting speed: up to 9.6m/min Cutting direction: reversible (to cut in) Max. cutting capacity: 50mm
<b>RHGS502</b>	<b>Machine base</b> for P500-series
<b>RHGS503</b>	<b>Roller conveyor</b> Width: 800mm with guide rail
<b>RHGS504</b>	Machine base for roller conveyor

## Battery shears

### EC Cutter

#### EC CUTTER BATTERY SHEARS

WIDIA tipped cutting blades with micro serration

For Technical Textiles like Aramid, Carbon and Fiberglass up to 450g/m<sup>2</sup>



EC Cutter Set



EC Cutter Holster

item code	description
<b>RH Battery shears</b>	
<b>RHECCutterSE</b>	Battery Shears Set EC Cutter: 1 serrated cutting head for radii, 1 serrated cutting head with foot plate, 1 battery, 1 AC adapter, charger and transformer.
<b>RHECCutterSKRSE</b>	Cutting head serrated for radii EC Cutter
<b>RHECCutterSKFPSE</b>	Cutting head serrated with foot plate EC Cutter
<b>RHECCutterAKKU</b>	Battery EC Cutter
<b>RHSCKOEECutter</b>	Holster with belt loop, black synthetic leather for EC Cutter

weight: only 220g

Design: ergonomically moulded

Cutting heads changing: tool less

Battery: easy to change for continuous working without cord

Cutting material: all kind of textiles up to 450g/m<sup>2</sup>

## RH WBT-1 Battery Shears

**WIDIA tipped, optional micro-serrated cutting blades**

RH WBT-1: for textiles, canvas, leather, PVC, rubber, plastic film, carton  
 RH WBT-1-SE: for Technical Textiles like Aramid, PBO, Dyneema, Carbon and Fiberglass



WBT-1 accessories

item code	description
<b>RH battery shears</b>	
<b>RHWBT-1</b>	Battery shears set RH WBT-1 includes: 1 standard edge cutting head, 1 knife-edge cutting head, 1 battery, 1 charging station + power supply, 1 power supply for working with power cable
<b>RHWBT-1-SE</b>	Battery shears set RH WBT-1SE includes: as above, but <b>both cutting heads with micro-serration</b>
<b>RHWBT-1-SKKE</b>	replacement-knife-edge cutting head (A) for WBT-1-Cutter
<b>RHWBT-1-SKKE</b>	As above, but <b>micro-serrated</b>
<b>RHWBT-1-SKSTD</b>	Replacement standard-edge cutting head (B) for WBT-1-Cutter
<b>RHWBT-1-SKSE</b>	As above but <b>micro-serrated</b> (B) for aramid, PBO, Dyneema
<b>RHWBT-1-AKKU</b>	Replacement-battery for WBT-1

- Weight: only 300g
- Cutting heads: toolless changeable
- Cutting capacity: up to 1000g/m<sup>2</sup>
- Handle: ergonomic
- Battery: exchangeable for fast continuous work



## Battery Shears

### RH WBT-2 Battery Shears

#### Cutting heads with carbide inlay

RH WBT-2: for textiles, canvas, leather, PVC, rubber, plastic film, carton

RH WBT-2-SE: for technical textiles like aramid, PBO, Dyneema, carbon and fiberglass

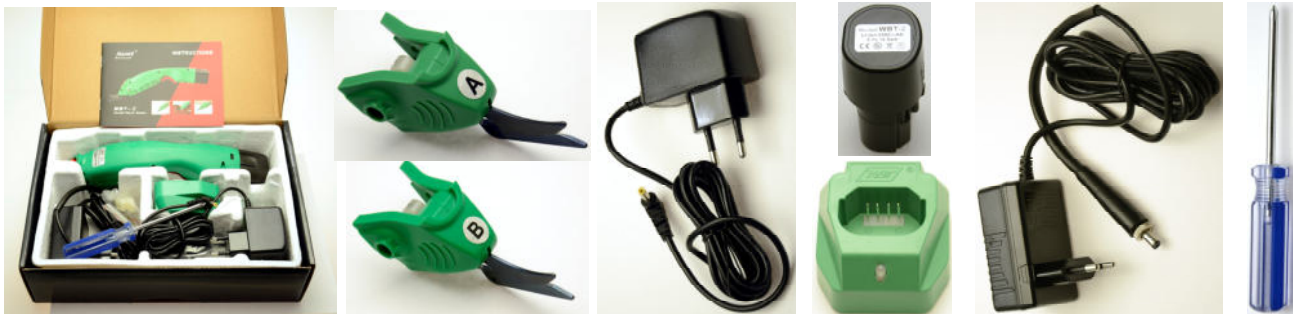

Artikel-Code	Beschreibung
<b>RH WBT-2</b>	
<b>RHWBT-2</b>	Battery shears-Set RH WBT-2 includes: 1 standard cutting head (B), 1 cutting head knife edge (A), 1 battery, 1 charging station + power supply, power supply for working with power cable
<b>RHWBT-2-SE</b>	As above, but with serrated cutting heads
<b>RHWBT-2-SKKE</b>	replacement-knife-edge cutting head (A) for WBT-2-Cutter
<b>RHWBT-2-SKKESE</b>	As above, but <b>micro-serrated</b>
<b>RHWBT-2-SKSTD</b>	Replacement standard-edge cutting head (B) for WBT-2-Cutter
<b>RHWBT-2-SKSE</b>	As above but <b>micro-serrated</b> (B) for aramid, PBO, Dyneema
<b>RHWBT-2-AKKU</b>	Replacement-battery for WBT-2

- weight: only 350g
- Battery: exchangeable for fast continuous work

## EASTMAN WorkerBee™ Battery Shears

EASTMAN WORKERBEE™ Battery Shears is designed with the same precision cutting features as our standard rotary shears but with the convenience and portability that is afforded by battery power.



**Pelican Option:**  
to cut lofted material  
with ease

RH Battery Shears **EC360**  
for fiberglass, carpet, textiles,  
PVC and fleece

item code	description
Battery shears	
<b>EAWORKERBEE</b>	EASTMAN WORKERBEE battery Shears, blade 2.03" (5.16cm) Maximum cutting height: 9.6mm
<b>EAWORKERBEE-PH</b>	EASTMAN WORKERBEE battery Shears, blade 2.03" (5.16cm) incl. pelican option
<b>RHEC360</b>	Battery shears EC360 incl. charger, battery, sharpening device, 10-bow-blade, Ø 60mm, weight 1.2kg
<b>RHEC360A51</b>	Extra Battery for EC360

# Oscillation cutter

## RH oscillating cutter with pneumatic cutting head

- For technical textiles like carbon, glass-fibres and PREPREGS. Also for rubber, PVC, carton and further thick or sticky materials.
- Cutting head for integration in CNC or linear systems



**RH oscillation cutter, pneumatic**

item code	description
RH oscillation cutter	
RHOSZICUT	<p>RH oscillation cutter with pneumatic cutting head for usage with full carbide knives. For fast cutting by oscillation..</p> <p><b>Technical data:</b> frequency: up to 9000 strokes/min Max. cutting capacity: 120mm, depending on material to cut. Length of handle: ca. 150mm Diameter of handle: 39mm weight: 1.0kg</p>

## RH Heat-Cutters

- For synthetic textiles
- For cut-to-length and melting the heads of technical textiles and cords



HSG-0 with cutting blade „R“



HSG-0 electronic with cutting blade „R-50“



HSG-1VW for continuous operation



HSG-3VW continuous operation

We have other devices and special machines in our program, please contact us.

item-code	description
<b>Heat-cutters</b>	
<b>RHHSG-0</b>	Heat-cutter 60W/230V, 1.1kg, handheld-device for short-term operation, for small quantities
<b>RHHSG-0ELE</b>	Heat-cutter 120W/230V 0.45kg, handheld-device for short-term operation, for small quantities
<b>RHHSG-1VW</b>	Heat-cutter/ Transformer 160W/230V, for small and medium quantities, infinitely variable temperature
<b>RHHSG-3VW</b>	Heat-cutter/ Transformer 250W/230V with pre-heating, faster working due to adjustable stand-by temperature, infinitely variable working temperature
<b>RHHSGSP-R</b>	Cutting blade „R“, for cutting stronger fabrics, cords and ropes up to Ø 15mm
<b>RHHSGSP-R-50</b>	Cutting blade „R-50“, for cutting stronger fabrics, cords and ropes up to Ø 35mm





## Scissors

### RH TECHTEX scissors with knife-edge 1 blade micro-serrated

For technical textiles like carbon, fiberglass and aramid  
40% less weight, 50% more power, 100% more durability\*



\* compared to classically, hot drop forged scissors

item code	description	length		weight
RH Techtex-scissors		total mm	blade mm	g
<b>SCKAI7205SE</b>	TECHTEX Schere KAI 8“, serrated	205	80	200
<b>SCKAI7230SE</b>	TECHTEX Schere KAI 9“, serrated	230	90	210
<b>SCKAI7250SE*</b>	TECHTEX Schere KAI 9,5“, serrated	250	95	220
<b>SCKAI7250LSE</b>	TECHTEX Schere KAI 9,5“, serrated <b>LEFTHANDED</b>	250	95	220
<b>SCKAI7280SE</b>	TECHTEX Schere KAI 11“, serrated	280	115	260
<b>SCKAI7300SE</b>	TECHTEX Schere KAI 12“, serrated	300	125	315

\*bestseller

Steel: high alloyed special tool steel, hardness HRC59,0 with high toughness

High durability, sharpening possible

Blades: 1 blade micro-serrated to avoid slipping-away of material

Handles: ergonomically moulded elastomeric plastic

Screw: hardened

Technology: break proof, cut out by laser from one peace

Long lever technology for easy cutting of heavy-duty materials

## Scissors

### RH TECHTEX scissors knife-edge

Ideal for rubber, PVC, foil, foam and thick fabrics  
40% less weight, 50% more power, 100% more durability\*



\* compared to classically, hot drop forged scissors

item code	description	length		weight
RH Techtex-scissors		total mm	blade mm	g
SCKAI7205	TECHTEX Schere KAI 8“	205	80	200
SCKAI7230	TECHTEX Schere KAI 9“	230	90	210
SCKAI7250*	TECHTEX Schere KAI 9,5“	250	95	220
SCKAI7250L	TECHTEX Schere KAI 9,5“ LEFTHANDED	250	95	220
SCKAI7280	TECHTEX Schere KAI 11“	280	115	260
SCKAI7300	TECHTEX Schere KAI 12“	300	125	315

\*bestseller

Steel: high alloyed special tool steel, hardness HRC59,0 with high toughness

High durability, sharpening possible

Blades: knife-edge

Handles: ergonomically moulded elastomeric plastic

Screw: hardened

Technology: break proof, cut out by laser from one peace

Long lever technology for easy cutting of heavy-duty materials



1253/4/S/7"



322/S/5"



615/S/5"



1024/S/10"



1071/S/7,5"



1026/S



## ROBUSO®-proton® scissors and shears

Micro-serrated blades

For cutting technical textiles like aramid, kevlar, Twaron and Dyneema  
AlTiN coated with HV3300 hardness

total length  
cutting length  
weight

Item-code	Description	
<b>ROBUSO®-proton®--Scheren</b>		
<b>SCRO615S5</b>	ROBUSO proton thread trimming scissors for use with light-weight Aramide and Dyneema thread material, both blade micro-serrated, round tip to wear as a pocket scissors	13cm 4,2cm 48g
<b>SCRO322S5</b>	ROBUSO proton thread trimming scissors for use with light-weight Aramide and Dyneema thread material, both blade micro-serrated, round tip to wear as a pocket scissors	13,3cm 4,0cm 56g
<b>SCRO12534S7</b>	ROBUSO proton mould making scissors for use with light-weight Aramide and Dyneema thread material, one blade micro-serrated, with blades and handles bent-up	18,5cm 6,5cm 111g
<b>SCRO1071S775</b>	ROBUSO proton scissors for use with light- to medium weight Aramide and Dyneema fabrics, one blade micro-serrated for forceful, short-length cuts	20cm 5,0cm 208g
<b>SCRO1041S8</b>	ROBUSO proton scissors for use with light- to medium weight Aramide and Dyneema fabrics, one blade micro-serrated, for <b>LEFTHANDED</b>	21cm 9cm 191g
<b>SCRO1026S8</b>	ROBUSO proton scissors for use with light-weight Aramide and Dyneema fabrics, one blade micro-serrated, unusually high cutting efficiency right down into the tips.	21cm 8,0cm 166g
<b>SCRO1026S95</b>	ROBUSO proton scissors for use with light-weight Aramide and Dyneema fabrics, one blade micro-serrated, unusually high cutting efficiency right down into the tips.	25cm 9,5cm 230g
<b>SCRO1024S10</b>	ROBUSO proton shears for use with light- to medium weight Aramide and Dyneema fabrics, one blade micro-serrated, positive leverage factor provides effortless cutting	26cm 10,0cm 361g
<b>SCRO1041S10</b>	ROBUSO proton shears for use with light- to medium weight Aramide and Dyneema fabrics, one blade micro-serrated, positive leverage factor provides effortless cutting, for <b>LEFTHANDED</b>	26cm 10,5cm 340g

made of forged and hardened C60 carbon steel  
completely proton-coated  
super-hardened surface  
controlled non-slip cutting

finger loops manually fine-polished  
micro-serrated blade(s)  
extreme ease of handling

1081/C/8,5"



1041/C



405/C



1024/C



seit 1919

1026/C



1071/C/7,5"



## ROBUSO® Scissors

One blade micro-serrated

For technical textiles like aramid, carbon- and glass-fibre

total length  
cutting length  
weight

item-code	description	
<b>ROBUSO®-scissors for techical textiles</b>		
<b>SCRO405C55</b>	ROBUSO Glass-fibre scissors 5.5" for light work, one blade micro-serrated	14,5cm 4,5cm 54g
<b>SCRO405C6</b>	ROBUSO Glass-fibre scissors 6.0" for light work, one blade micro-serrated	16cm 5cm 55g
<b>SCRO4052CR6</b>	ROBUSO Glass-fibre scissors 5.5" for light work, one blade micro-serrated, chrome plated	like above
<b>SCRO1071C775</b>	ROBUSO Heavy-Duty-scissors 7.75" for short and powerful cuts into glass- and carbon-fibre, aramid, knitted fabric and felt	20cm 5cm 208g
<b>SCRO1026C8</b>	ROBUSO Trimming shears 8.0" for light and medium glass fibre, aramid and Dyneema®, one blade micro-serrated, especially powerful due to special shape	21cm 8cm 166g
<b>SCRO10263C8</b>	ROBUSO Trimming shears 8.0" for light and medium glass fibre, aramid and Dyneema®, one blade micro-serrated, especially powerful due to special shape, cranked handles for trimming edges	21cm 8cm 166g
<b>SCRO1041C8</b>	ROBUSO Tailor's shears 8" for technical textiles, for <b>LEFTHANDED</b>	21cm 9cm 191g
<b>SCRO1081C85</b>	ROBUSO Aramid-shears 8.5", for short and powerful cuts in light and medium glass-, carbon-, and aramid-fabrics, one blade micro-serrated	22,5cm 6,5cm 240g
<b>SCRO1024C10</b>	ROBUSO Trimming shears 10" for glass- and aramide-fabrics and Dyneema®, one blade micro-serrated	26cm 10cm 361g
<b>SCRO1041C10</b>	ROBUSO Tailor's shears 10" for technical textiles, for <b>LEFTHANDED</b>	26cm 10,5cm 340g
<b>SCRO1026C95</b>	ROBUSO Trimming shears 9.5" for light and medium glass-fibre, aramid and Dyneema®, one blade micro-serrated, especially powerful due to special shape	26cm 10cm 361g
<b>SCRO1024C1275</b>	ROBUSO Trimming shears 12.75" for glass-fibre, aramid and Dyneema®, one blade micro-serrated	33cm 13cm 553g

aus C60 Kohlenstoffstahl geschmiedet und gehärtet  
Einseitig microverzahnte Schneiden

Blätter sind blau gepließt  
Griffige, pulverbeschichtete Griffe

405/2/B-CR/6"



1253/4/B-CR/7"



1076/4/B-CR/7"



615/E/5"



1249/4/6"



322/E



1026





## ROBUSO® Mould-trim- and weaver's shears

One blade micro-serrated

Mould-trimming shears with curved-up blades

For trimming while laminating aramid, carbon- and glass-fibre

Profile view of a scissors with cranked handles and curved-up blades



total length  
cut.- length  
weight

item-code	description	
<b>ROBUSO® - Mould-trimming shears</b>		
<b>SCRO615E5</b>	ROBUSO Weaver's shears 5", nickel plated, hollow ground, powerful model, one blade micro-serrated	13cm 4,2cm 48g
<b>SCRO322E5</b>	ROBUSO Weaver's shears 5", nickel plated. For cutting threads of glass- carbon- and aramid. Hollow ground, one blade micro-serrated	13,2cm 5cm 56g
<b>SCRO322E5RD</b>	Like above, but with both blades micro-serrated and rounded tip	like above
<b>SCRO4052CR6</b>	ROBUSO Mould-trimming shears 6", chrome plated. Fine tapered blades, hardened screw, large finger-loops, blades curved up	16cm 5cm 60g
<b>SCRO12494E6SE</b>	ROBUSO Mould-trimming shears 6", chrome plated. Very light model for delicate, precise cutting purpose. Cranked handles, curved-up blades, rounded tip	16cm 6cm 38g
<b>SCRO12534CR7</b>	ROBUSO Mould-trimming shears 7", chrome plated. Powerful model for glas- and carbon fibre, and wet laminates. Cranked handles, curved-up blades.	18,5cm 4,5cm 85g
<b>SCRO10764CR7</b>	ROBUSO Mould-trimming shears 7", chrome plated. Light shears for thin glas- and carbon fibre, and wet laminates. Both blades micro-serrated, cranked handles, curved-up blades.	18,5cm 6,5cm 111g
<b>SCRO10262CR8SE</b>	ROBUSO Mould-trimming shears 8", chrome plated, Slim trimming shears, curved-up blades	21cm 8cm 166g
<b>SCRO10264CR8SE</b>	Like above, but with cranked handles	like above

C60 forged and hardened carbon steel  
Finger loops manually fine-polished  
One blade micro-serrated

Fine polished blades  
Fully chrome plated (except 322 and 615, nickel plated  
= solvent-resistant)

## Scissors

### RH TEC Industrial shears - NEW Series, hardness HRC62,0

- 2 - 10 x more durability guaranteed
- Stainless, straight, microserrated blades

**For technical textiles like carbon-fibre, glass-fibre, aramid, PBO, Dyneema®**



item-code	description	cut.-length / total length
<b>RH Tec Industrial shears</b>		
<b>SCRHTEC65-SE</b>	RH TEC weaver's scissors 6" HD, 1 x serrated, HIGH-TEC-steel, HRC62.0, plastic handles, weight: 65g	40 / 160mm
<b>SCRHTEC8-SE</b>	RH TEC industrial shears 8" HD, 1 x serrated, HIGH-TEC-steel, HRC62.0, plastic handles, weight: 90g	80 / 210mm
<b>SCRHTEC10-SE</b>	RH TEC industrial shears 10" HD, 1 x serrated, HIGH-TEC-steel, HRC62.0, plastic handles, weight: 205g	100 / 260mm

steel: high-alloy PM-steel, powder-sintered, hardness HRC62.0, for extreme durability, resharpenable

blades: one blade micro-serrated, so the cutting material will not slip away

handles: ergonomical formed plastic, acetone-resistant

pivot point offset to the tip, therefore particularly easy cutting of even heavy and strong materials

## Scissors

### RH TEC

- Special steel (NEW), hardness HRC62,0
- 2 - 10x more durability guaranteed
- Stainless, straight, micro-serrated blades

**For technical textiles like carbon-fibre, glass-fibre, aramid, Dyneema, PBO**

SCRHTEC6



SCRHTEC95



item-code	description
<b>RH Mould-trimming shears</b>	
<b>SCRHTEC6-SE</b>	RH TEC Weaver's shears 6", one blade micro-serrated, HIGH-TEC steel, plastic handles, cutting length: 60mm / total length: 155mm, weight: 47g
<b>SCRHTEC6-2xSE</b>	RH TEC Weaver's shears 6", both blades micro-serrated, HIGH-TEC steel, plastic handles, cutting length: 60mm / total length: 155mm, weight: 47g
<b>SCRHTEC95-SE</b>	RH TEC Industrial shears 9.5", one blade micro-serrated, HIGH-TEC steel, plastic handles, cutting length: 100mm / total length: 240mm, weight: 130g
<b>SCRHTEC95-2xSE</b>	RH TEC Industrial shears 9.5", both blades micro-serrated, HIGH-TEC steel, plastic handles, cutting length: 100mm / total length: 240mm, weight: 130g

Steel: high alloy tool-steel, resharpenable, hardness HRC 62.0

Blades: micro-serrated, to avoid slipping-away of the cutting material

Handles: ergonomical form, acetone-resistant

Pivot point offset to the tip, therefore particularly easy cutting

## Scissors

### ARS HIGHTECH-scissors

- Both blades micro-serrated
- Powder metallurgical steel with unrivalled HRC 72.0 hardness
- More power, 500,000 cuts in aramid guaranteed

**For technical textiles like aramid, PBO, Dyneema®**

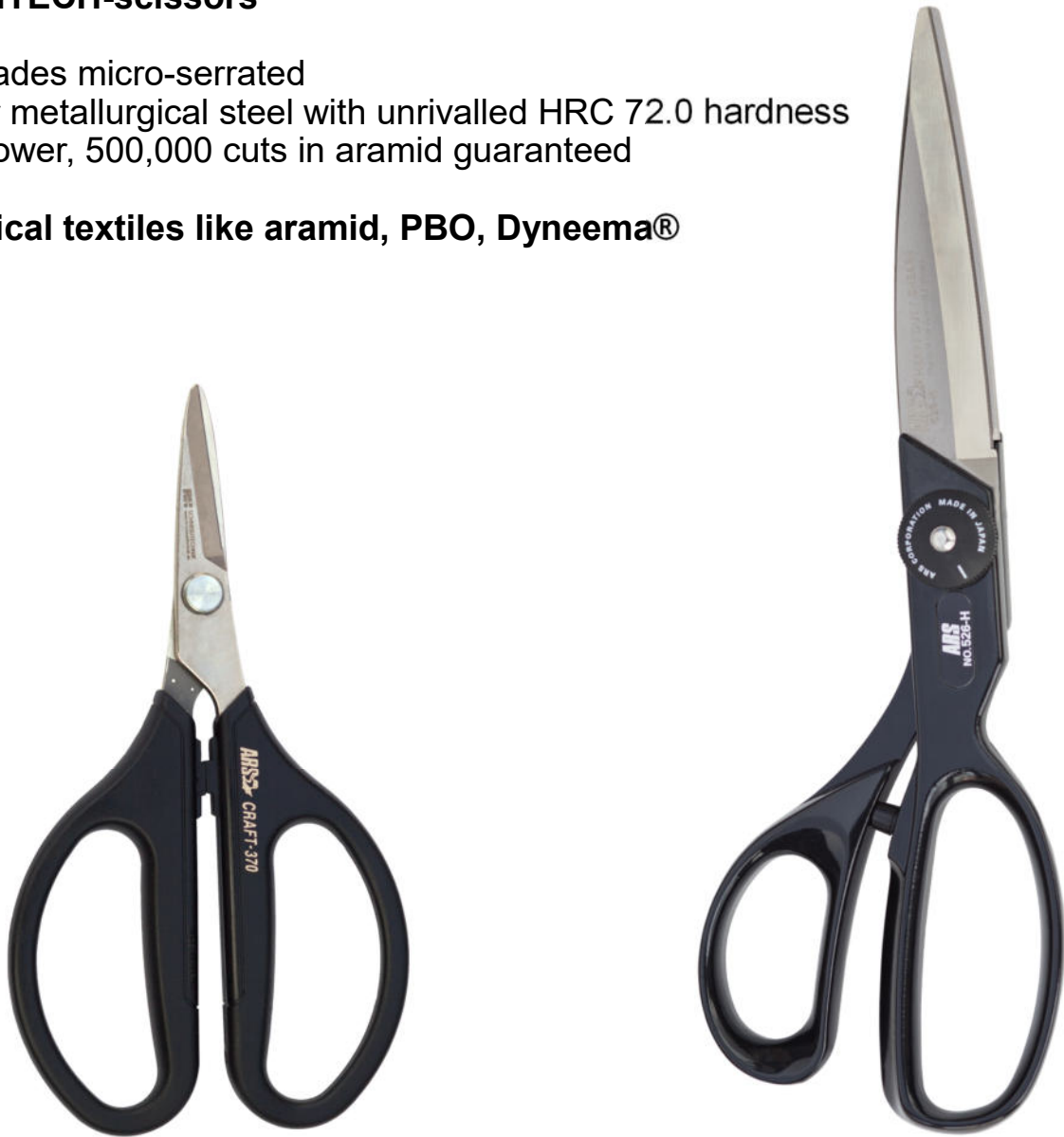

item-code	description
RH scissors, both blades micro-serrated	
<b>SCARSWEB6PM-2xSE</b>	ARS HIGHTECH scissors 10", both blades micro-serrated, cutting-length: 90mm / total length: 260mm, weight: 250g
<b>SCARSTECHTEX10PM-2xSE</b>	ARS HIGHTECH scissors 6", both blades micro-serrated, cutting-length: 35mm / total length: 160mm, weight: 70g

Steel: high-alloy PM steel, sintered, hardness HRC72.0, thus extremely wear-resistant, resharpenable

Blades: both blades micro-serrated to avoid slipping-away of the cutting material

Handles: 10"-model: ergonomically formed light-alloy / 6"-model: plastic

Screw: hardened: adjustable (10"-model)

Pivot point offset to the tip, therefore particularly easy cutting of heavy and strong materials



## Scissors

### RH Mould trimming- / Model making shears

1x micro-serrated, fully chrome plated  
For technical textiles, like aramid, carbon- and glass-fibres



item code	description
<b>RH mould trimming scissors</b>	
<b>SCRHIND6CRSE</b>	RH Industry scissors 6,0", <b>straight</b> , micro-serrated, cutting length: 55mm total length: 160mm, weight: 60g
<b>SCRHFOBAU6CRCSE</b>	RH Mould trimming scissors 6,0", <b>curved up</b> , micro-serrated, cutting length: 55mm, total length: 160mm, weight 60g
<b>SCRHFOBAU7CRCKCSE</b>	RH mould trimming scissors 7,0" <b>curved up</b> , micro-serrated, fully chrome plated, handles cranked, cutting length 70mm, total length 182mm, weight 112g
<b>SCRHIND775CRSE</b>	RH Heavy Duty industrial scissors 7,75", micro-serrated, fully chrome plated, cutting length 55mm, total length 193mm, weight 210g

Material: forged carbon steel C60, hardness HRC 58,0, grindable  
Cutting edge: 1 x micro-serrated to avoid „slipping away“ of cutting material  
Finish: fine polish, fully chrome plated, acetone resistant  
Made in SOLINGEN / GERMANY

## Scissors

### RH Mould-trimming shears

For technical textiles, like aramid, carbon- and glass-fibres



SCRHWEB

SCRHIND6



SCRHIND775



Steel: forged carbon-steel, resharpenable  
Micro-serrateion: avoids „slipping-away“ of cutting material  
Handles: ergonomical form with PVC-comfort-coating

## Scissors

SCRHIND7



SCRHFOBAU7CKSE



Profile view:

cranked handles  
curved-up blades

item-code	description
<b>RH Mould-trimming shears</b>	
<b>SCRHWEB45</b>	RH Mould-trimming shears 4.0", <b>straight</b> , chrome-plated
<b>SCRHWEB45SE</b>	RH Mould-trimming shears 4.0", <b>micro-serrated</b> , chrome-plated
<b>SCRHWEB45C</b>	RH Mould-trimming shears 4.0", <b>curved-up</b> , chrome-plated
<b>SCRHWEB45CSE</b>	RH Mould-trimming shears 4.0", <b>curved-up, micro-serrated</b> , chrome-plated
<b>SCRHWEB5</b>	RH Mould-trimming shears 5.0", <b>straight</b> , nickel-plated
<b>SCRHWEB5SE</b>	RH Mould-trimming shears 5.0", <b>micro-serrated</b> , nickel-plated
<b>SCRHWEB5-2xSERD</b>	RH Mould-trimming shears 5.0", <b>both blades micro-serrated</b> , rounded tip, nickel-plated
<b>SCRHIND6</b>	RH Industrial shears 6.0", <b>straight</b> , chrome-plated
<b>SCRHIND6SE</b>	RH Industrial shears 6.0", <b>curved-up</b> , chrome-plated
<b>SCRHIND6C</b>	RH Industrieschere 6.0", <b>curved-up</b> , chrome-plated
<b>SCRHIND6CSE</b>	RH Industrial shears 6.0", <b>curved-up, micro-serrated</b> , chrome-plated
<b>SCRHIND7</b>	RH Industrial shears 7.0", <b>straight</b> , chrome-plated
<b>SCRHIND7SE</b>	RH Industrial shears 7.0", <b>micro-serrated</b> , chrome-plated
<b>SCRHFOBAU7CKSE</b>	RH Mould-trimming shears 7.0", <b>curved-up, cranked handles, micro-serrated</b> , chrome-plated
<b>SCRHIND775SE</b>	RH <b>Heavy Duty</b> Industrial shears 7.75", <b>micro-serrated</b> , chrome-plated

## Scissors

### RH leightweight TECHTEX-Scissors

**Stainless, straight blades, micro-serrated, with comfort handle**

**For Technical textiles like fiberglass, carbon-fibre and aramid**



item-code	description
<b>RH light Tectex-scissors</b>	
<b>SCRHUNI7SE</b>	RH TECHTEX Universal shears 7", one blade micro-serrated, short, powerful blades, <b>BLUE</b> comfort-handles, cutting length: 35mm / total length: 180mm, weight: 120g
<b>SCRHUNI8-I</b>	RH TECHTEX Universal shears 8", strong blades, <b>GREY</b> comfort-handles, cutting length: 70mm / total length: 210mm, weight: 125g
<b>SCRHUNI8SE-I</b>	RH TECHTEX Universal shears 8", one blade micro-serrated, strong blades, <b>GREY</b> comfort-handles, cutting length: 70mm / total length: 210mm, weight: 125g
<b>SCRHNAE8</b>	RH TECHTEX Shears 8", slim blades, comfort-handles, cutting length: 80mm / total length: 210mm, weight: 105g
<b>SCRHTECHTEX8SE</b>	RH TECHTEX Shears 8", one blade serrated, slim blades, <b>RED</b> comfort-handles, cutting length: 80mm, total length: 210mm, weight: 105g
<b>SCRHNAE95</b>	RH TECHTEX SCISSORS 9.5", slim blades, <b>GREY</b> comfort-handles, cutting length: 110mm / total length: 240mm, weight: 115g
<b>SCRHIND95SE</b>	Like above, but one blade micro-serrated

Steel: high alloyed, stainless tool steel, Hardness HRC 55,0, resharpenable  
Blades: micro-serrated, avoids slipping of material, good lever = easy cutting  
Handles: ergonomic with comfort inlay, acetone-resistant  
100% made in SOLINGEN / GERMANY



## Scissors

### RH forged, stainless scissors



item-code	description
RH stainless, forged scissors	
<b>SCRHWEB5-2xSE</b>	RH Weaver's shears 5.0" TECHTEX for aramid-, glass- carbon-fibre threads, <b>rounded tip</b> , total length: 130mm, cutting length: 50mm, weight: 43g
<b>SCRHWEB5-2xSERD</b>	Weaver's shears 5.0" TECHTEX for aramid-, glass- carbon-fibre threads, <b>very rounded tip</b> , total length: 130mm, cutting length: 50mm, weight: 43g
<b>SCRHUNI8KH</b>	RH Industrial Shears 8.0" TECHTEX for glasse-fibre and carbon, handles satin-finished, blades polished, total length: 200mm, cutting length: 65mm, weight: 145g Also suitable as high-quality kitchen shears

Forged, stainless tool-steel, hardness: HRC 57.0

Adjustable screw

Made in Solingen / Germany

## Scissors sharpening service

### How can we help you?

- Sharpening service for scissors
- Custom-made scissors
- Hard-metal coating for machine knives
- Micro-serrating of machine knives from steel and hard-metal-knives

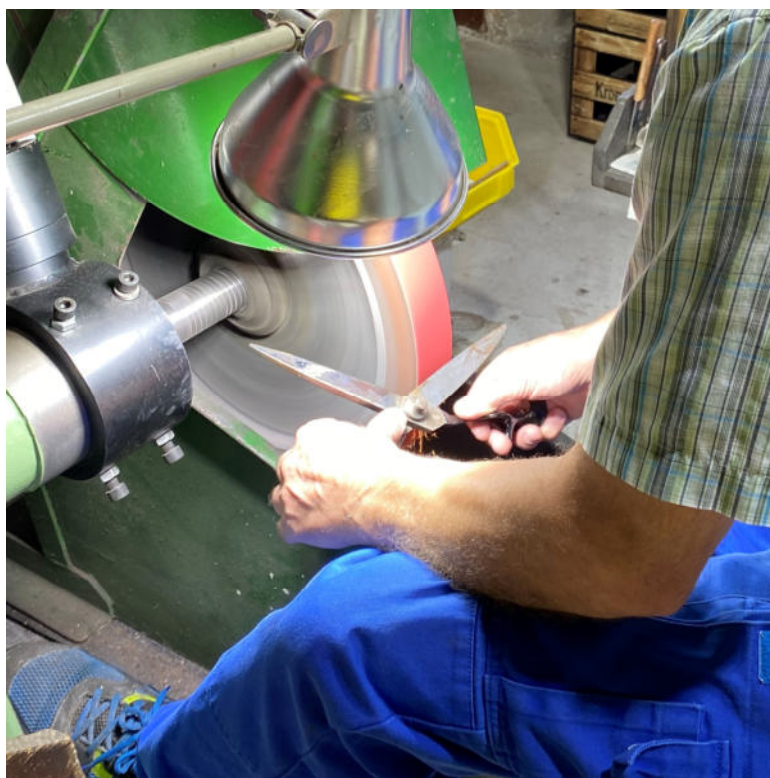

item-code	description
<b>RH Service</b>	
<b>SESC6</b>	Sharpening service scissors up to 6"
<b>SESC7</b>	Sharpening service scissors up to 7"
<b>SESC8</b>	Sharpening service scissors up to 8"
<b>SESC9</b>	Sharpening service scissors up to 9"
<b>SESC10</b>	Sharpening service scissors up to 10"
<b>SESC11</b>	Sharpening service scissors up to 11"
<b>SESC12</b>	Sharpening service scissors up to 12"

We dress, re-sharpen, serrate (if necessary) and quality-check the scissors you send us.

**Notes:**

## KAI Rotary-cutters

### KAI rotary-cutters and cutting-mats

Suitable for technical textiles like carbon and glass fibre + PVC



item-code	description
<b>KAI rotary-cutters and cutting-mats</b>	
<b>WEKAIRS45</b>	KAI rotary-cutter blue / black 45mm, softgrip-handle
<b>WEKAI5045</b>	KAI rotary-cutter grey, 45mm
<b>MEKAI5045BL</b>	Replacement blade for KAI- rotary-cutter, 45mm
<b>WEKAI5028</b>	KAI rotary-cutter grey, 28mm, for small radiuses
<b>MEKAI5028BL</b>	Replacement blade for KAI- rotary-cutter, 28mm, double pack
<b>WEKAICB02</b>	KAI cutting-mat 45 x 60cm
<b>WEKAICB01</b>	KAI cutting-mat 60 x 90cm
<b>WEKAICB143</b>	KAI cutting-mat 60 x 143cm
<b>WEKAICB200</b>	KAI cutting-mat 100 x 200cm, blue (without grid marks)

Blades: powder-metallurgical steel, hardness HRC 64.0 high durability makes low abrasion  
Cutting-mats: self-healing surface for long durability



## OLFA Rotary-cutters

### OLFA Rotary-cutters

Suitable for technical textiles like carbon and glass fibre + PVC



RTY-4



RTY-1G



RTY-2G



RTY-2NS



RTY-3G



RTY-3NS

item-code	description
<b>OLFA rotary-cutters</b>	
<b>WEOLFARTY4</b>	OLFA rotary-cutter RTY-4, blade Ø 18mm
<b>WEOLFARTY1G</b>	OLFA rotary-cutter RTY-1G, blade Ø 28mm
<b>WEOLFARTY2G</b>	OLFA rotary-cutter RTY-2G, blade Ø 45mm
<b>WEOLFARTY2NS</b>	OLFA rotary-cutter, luxus version with soft-grip-coating, blade Ø 45mm
<b>WEOLFARTY3NS</b>	rotary-cutter, luxus version with soft-grip-coating, blade Ø 60mm, with safety-lock
<b>WEOLFARTY3G</b>	OLFA rotary-cutter RTY-3G, blade Ø 60mm, with safety-lock
<b>MEOLFARB18-10</b>	10-pcs.-pack of spare blades for OLFA rotary-cutters blade Ø 18mm
<b>MEOLFARB28-10</b>	10-pcs.-pack of spare blades for OLFA rotary-cutters blade Ø 28mm
<b>MEOLFARB45-10</b>	10-pcs.-pack of spare blades for OLFA rotary-cutters blade Ø 45mm
<b>MEOLFARB60-1</b>	spare blade for OLFA rotary-cutters blade Ø 60mm

Blades: powder-metallurgical steel, hardness HRC 64.0 high durability makes low abrasion. Double durability compared to standard blades.

## OLFA-Stanley-knives and cutting mats

XA-1



180 black



A-1



SVR-2



SAC-1



FWP-1



PL-1



L1



L-5



L-5A



NOL-1



NL-AL



SL-1



ML



## OLFA-Stanley-knives

XH-1



XH-AL



item-code	description
<b>OLFA Stanley knives</b>	
<b>WEOLFAXA-1</b>	OLFA Stanley-knife standard, blade Ø 9mm
<b>WEOLFA180BLACK</b>	OLFA Stanley-knife standard, black, blade Ø 9mm
<b>WEOLFAA-1</b>	OLFA Stanley-knife standard, blade Ø 9mm
<b>WEOLFAA-5</b>	OLFA Stanley-knife standard, blade Ø 9mm
<b>WEOLFASVR-2</b>	OLFA Stanley-knife standard, blade Ø 9mm
<b>WEOLFASAC-1</b>	OLFA Stanley-knife standard, blade Ø 9mm, 30° cutting edge
<b>WEOLFAPWP-1</b>	OLFA Stanley-knife standard, blade Ø 12.5mm
<b>WEOLFAPL-1</b>	OLFA Stanley-knife for heavy materials, blade Ø 18mm, with blade-reloader
<b>WEOLFAL1</b>	OLFA Stanley-knife for heavy materials, blade Ø 18mm, with blade-reloader
<b>WEOLFAL-5</b>	OLFA Stanley-knife for heavy materials, blade Ø 18mm, with thorn at backend for opening cartons without damaging the content, with fixing-screw
<b>WEOLFAL-5A</b>	OLFA Stanley-knife for heavy materials, blade Ø 18mm, with thorn at backend for opening cartons without damaging the content
<b>WEOLFANOL-1</b>	OLFA Stanley-knife for heavy materials, blade Ø 18mm, with fixing-screw
<b>WEOLFANL-AL</b>	OLFA Stanley-knife for heavy materials, blade Ø 18mm
<b>WEOLFASL-1</b>	OLFA Stanley-knife for heavy materials, blade Ø 18mm
<b>WEOLFAML</b>	OLFA Stanley-knife for heavy materials, blade Ø 18mm
<b>WEOLFAXH-1</b>	OLFA Stanley-knife for heavy materials, blade Ø 25mm
<b>WEOLFAXH-AL</b>	OLFA Abbrechmesser für besonders schwere Materialien, Klinge 25mm, mit Feststell-Schraube

Blades: high-alloy tool steel, high hardness and toughness. At least twice the durability of conventional blades.



**RH Schneidtechnik**  
**Neuenhofer Str. 75**  
**42657 Solingen**  
**Tel. +49 (0)212 2354300**  
**Fax +49 (0)212 2354301**  
**[www.rh-schneidtechnik.de](http://www.rh-schneidtechnik.de)**  
**[rainer.hueckelhoven@rh-schneidtechnik.de](mailto:rainer.hueckelhoven@rh-schneidtechnik.de)**

**Wir vertreten exklusiv:**  
**[www.rasor-cutters.com](http://www.rasor-cutters.com)**  
**[www.elaxa.de](http://www.elaxa.de)**  
**[www.eastmancuts.com](http://www.eastmancuts.com)**